

PULSE SERIES

PULSE 2X650

The Pulse Series amplifiers are high performance professional power amplifiers capable of delivering major power output from a new generation of switched mode power supplies. All Pulse Series amplifiers are housed in the same size 2U cases and feature light, powerful switching power supplies along with massive heatsinks and two dual-speed fans. Microprocessor supervision of the power supplies, protection and thermal systems ensures that the amplifier is always operating correctly thereby protecting both the amplifier and your speakers from failure.

Pulse Series amplifiers are as equally at home in critical fixed installations and in demanding, live touring sound environments. Capable of maintaining excellent performance when being driven to their limit with real loud-speaker loads, Pulse amplifiers are solid and reliable—an amp you can count on.

At Crown, sonic performance is always in the forefront of our minds. Like all Crown amps, Pulse Series amplifiers have undergone rigorous testing in order to ensure their sonic quality and reliability. And every Pulse amplifier is backed by Crown's unequalled Three-Year, No-Fault, Fully-Transferable Warranty that covers everything.

For more details about the Pulse Series, contact the Crown Technical Support Group at 800-342-6939 or 219-294-8200. Also, visit the Crown Audio website at www.crownaudio.com.

Specifications

Input Sensitivity: +1 dBu for full output.

Input Impedance: 20 kohm.

Input Connectors: 1/4-inch TRS balanced phone jack, removable terminal block, male and female XLR.

Distortion: <0.006% THD, 1 kHz, 1 dB below clip, 22 kHz measurement bandwidth.

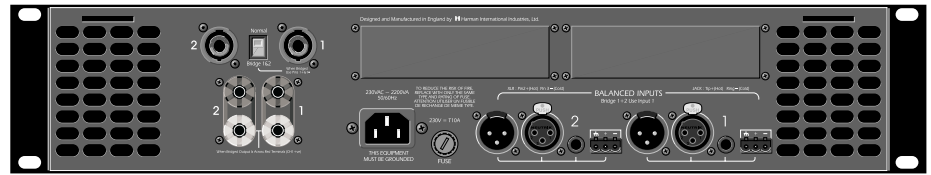

Features

- **Switch Mode Power Supply** delivers great performance without the weight.
- **Microprocessor supervision of power supplies** provides overall system protection.
- **Accurate front-panel indicators and level controls.**
- **Choice of balanced XLR, 1/4-inch phone and removable barrier block inputs.**
- **Choice of Speakon® and/or binding post outputs.**
- **All this performance and reliability in only 2 rack spaces.**

Frequency Response: 20 Hz to 20 kHz, +0/-0.2 dB; <2 Hz to >120 kHz +0/-3 dB.

Controls: Power switch, bridge mode switch, detented level controls (these may be made tamper-proof).

Power Output Power:

	*1 kHz Power
2-ohm Dual (per channel)	850W**
4-ohm Dual (per channel)	650W
8-ohm Dual (per channel)	400W
4-ohm Bridge-Mono	1700W**
8-ohm Bridge-Mono	1300W

*1 kHz Power: refers to maximum average power in watts at 1 kHz with 0.1% THD+N.

**Note: 2 ohm dual and 4 ohm bridge are at 1% THD.

Indicators: AC Present, Operate, Signal, Bridge, Clip, Temp, Fault.

Protection (microprocessor supervised): Over-temperature, DC on outputs, output stage overload, inrush current surge, power fail and brownout.

Noise: <-100 dB ref. full output 20 Hz to 20 kHz measurement bandwidth.

Slew Rate: >50 V/microsecond.

Damping Factor: >200 ref. 8 ohm.

Output Connectors: Binding post and Speakon®.

AC Power: 230 volts AC nominal, 2200VA, all channels driven.

Dimensions: 89 mm (3.5 in.) x 460 mm (18.2 in.) x 483 (19 in.).

Weight: 11 kg (24 lbs.).

Crown's Three-Year, No-Fault, Fully Transferable Warranty

Crown offers a Three-Year, No-Fault, Fully Transferable Warranty for every new Crown amplifier—an unsurpassed industry standard. With this unprecedented No-Fault protection, your new Crown amplifier is warranted to meet or exceed original specifications for the first three years of ownership. During this time, if your amplifier fails, or does not perform to original specifications, it will be repaired or replaced at our expense. About the only things not covered by this warranty are those losses normally covered by insurance and those caused by intentional abuse. And the coverage is transferable, should you sell your amplifier.

See your authorized Crown dealer for full warranty disclosure and details. For customers outside of the USA, please contact your authorized Crown distributor for warranty information or call 219-294-8200.



H A Harman International Company

Crown International
P.O. Box 1000
Elkhart, IN 46515-1000
TEL: 219-294-8200
FAX: 219-294-8FAX
www.crownaudio.com

Specifications subject to change without prior notice. Latest information available at www.crownaudio.com.

Crown is a registered trademark of Crown International. Other trademarks are the property of their respective owners. Printed in U.S.A.

© 2001 Crown Audio, Inc.