

ITEM NO.	PART NUMBER	DESCRIPTION	QTY.
1	55231003 Base	Base assembly	1
2	55231004 Yoke	Yoke assembly	1
3	08070710-A	M4x12 bh torx black	3
4	08111205-A	M6x22 ch allen black	6
5	55231001 Head cooling	Coolling lamp section	1
6	55231002 Effect module	Effect Module	1
7	62406100-A	Yoke side cover, MAC200	2
8	62406080-A	Base sidecover asm	2
9	08091206-A	M5x20 Allen screw black	4
10	23402040-C	Base interfacecover A	1
11	62328025-A	MAC200 Display cover	1
12	62406075-B	Bottom plate asm	1
13	08070709-A	M4x10 bh torx black	8
14	55231005 Front cover	MAC200 Front cover	1
15	08070804-A	M4x10 cs torx tapt black	4
16	55231007 PCB module	PCB module smartMAC	1

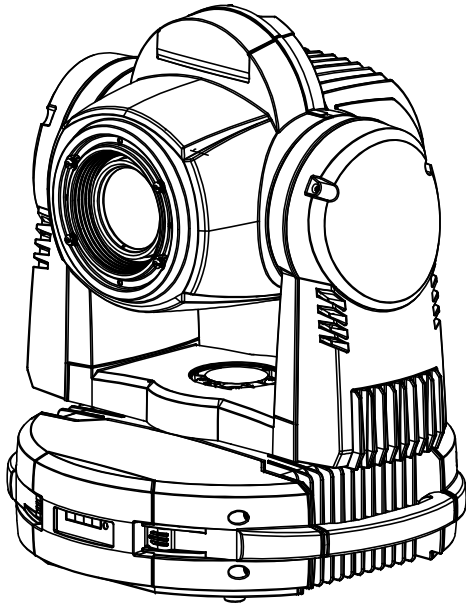

A 21.12.2007		RD TSA	First release		
Rev.	Date	Resp.	CO no. / Comment		
Martin		First used in MAC 200	Material		
Item to be		General linear tolerance			
Item to be		General angular tolerance			
Item to be		Color	Format A2	Scale 1:3	Unit mm
Description (Model in view 90231000 smartMAC)					Item no.-Rev. 90231000 smart

ITEM NO.	PART NUMBER	DESCRIPTION	QTY.
1	08053701-A	SO-M3-4 ZI	4
2	18240110-D	Display plate	1

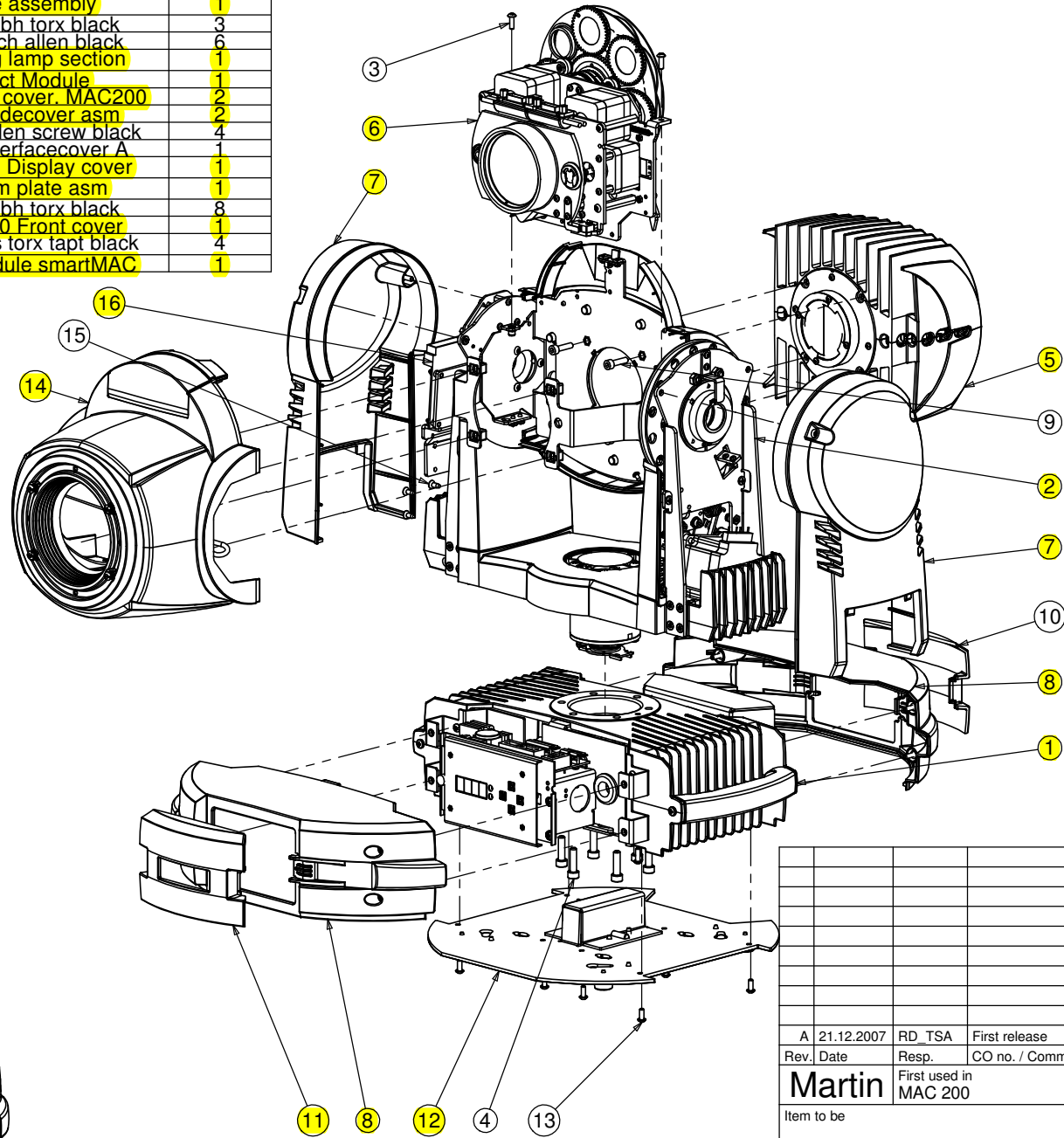
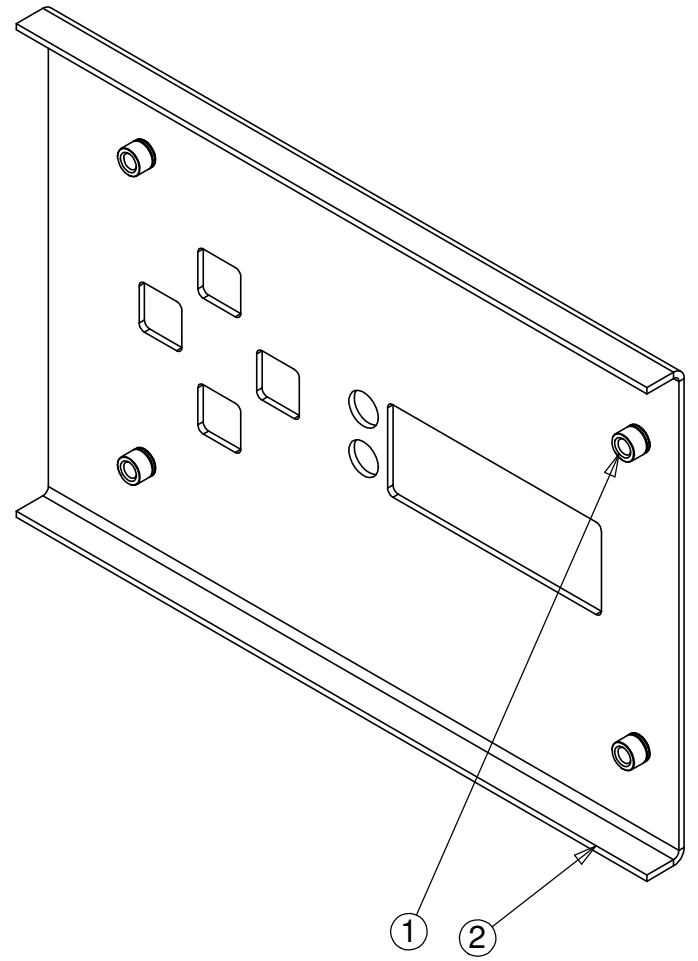

B	17.12.2007	rdtsa	BOM update		
A	07.02.2007	rdtsa	First Release		
Rev.	Date	Resp.	CO no. / Comment		
Martin		First used in MAC 200	Material		
Item to be			General linear tolerance		
Item to be			General angular tolerance		
Item to be		Color	Format A4	Scale 1:1	Unit mm
Description (Model in view 62406076-B)			Item no.-Rev.		
Display plate press			62406076-B		

Martin Quality Agreement apply to this item

ITEM NO.	PART NUMBER	DESCRIPTION	QTY.
1	08073601-A	M4 rivet nut cs splined 1-3mm	6
2	23816980-E	Base plate mains	1

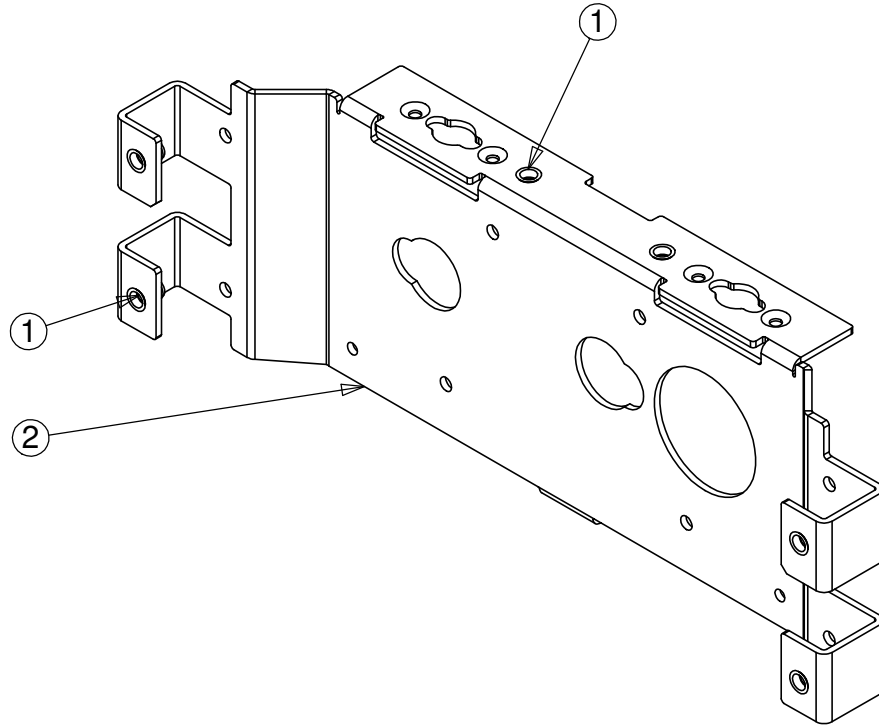

C	14.01.2008	rdtsa	BOM update
B	12.12.2007	rdtsa	BOM update
A	07.02.2007	rdtsa	First Release
Rev.	Date	Resp.	CO no. / Comment
Martin		First used in MAC 200	Material
Item to be		General linear tolerance	
Item to be		General angular tolerance	
Item to be		Color	Format A4
			Scale 1:1
			Unit mm
Description (Model in view 62406069-C)			Item no.-Rev.
Isolator plate base mains			62406069-C

ITEM NO.	PART NUMBER	DESCRIPTION	QTY.
1	18260300-A	Condensor plate	1
2	08073601-A	M4 rivet nut cs splined 1-3mm	2

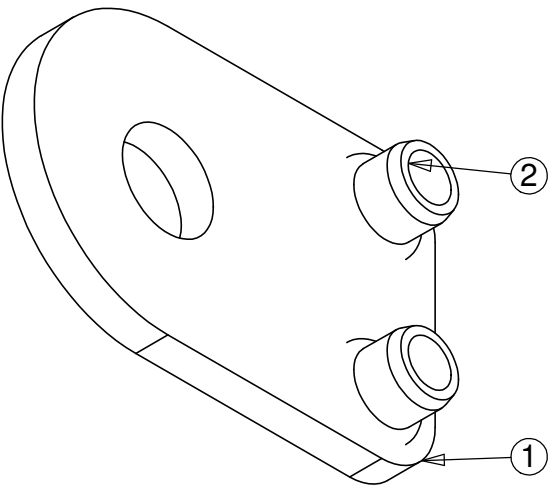

A	07.02.2007	rdtsa	First Release		
Rev.	Date	Resp.	CO no. / Comment		
Martin		First used in MAC 200	Material		
Item to be			General linear tolerance		
Item to be			General angular tolerance		
Item to be		Color	Format A4	Scale 2:1	Unit mm
Description (Model in view 62406098-A)				Item no.-Rev.	
Condensor Plate asm				62406098-A	

Martin Quality Agreement apply to this item

ITEM NO.	PART NUMBER	DESCRIPTION	QTY.
1	08070702-A	M4x6 ph torx tapt spike black	4
2	23006530-A	Yoke bottom cover	1
3	62406140-A	MAC200 bottom yoke asm	1
4	08070708-A	M4x8 bh torx black	12
5	62406085-A	Yokearm tilt motor side	1
6	06020003-A	Starter, NI 400 LE 4K-TU	1
7	23817400-F	Starter Bracket	1
8	62406086-A	Yokearm PCB side	1
9	08070801-A	M4x8 cs torx black	16
10	23817630-B	Heat Shield	1
11	08200108-A	4x10 eco-syn ph black	7
12	17820640-B	Spacer plate side chassis	1
13	08070805-A	M4x8 cs torx tapt spikes black	4
14	08070709-A	M4x10 bh torx black	9
15	08050700-A	M3x6 ph torx tapt spike black	2
16	62090177-A	PCBA, Hallsensor, smartMAC	1
17	23402000-D	Yoke inner cover, Mac 200	2
18	08190301-A	3.9x9.5 C. rec. Ph. Selftap bl	8
19	08050710-A	M3x5 ph torx tapt black	2
20	62400584-B	Head Chassis asm	1
21	13201012-A	Shaft for wireset	2
22	08050802-A	M3x6 cs torx black	2
23	23903220-A	Yoke top cover asm	1
24	23402140-C	Head Fixed Plastcover	1
25	05040022-A	145/130 Thermostat Air 36TXE11	1
26	33002521-A	Voltage insulation, hall censor	1
27	23818670-A	Wire leading clip	1

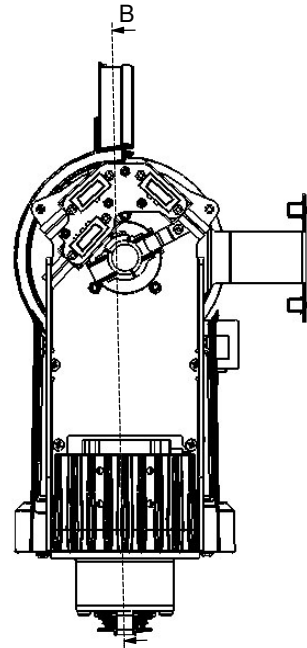
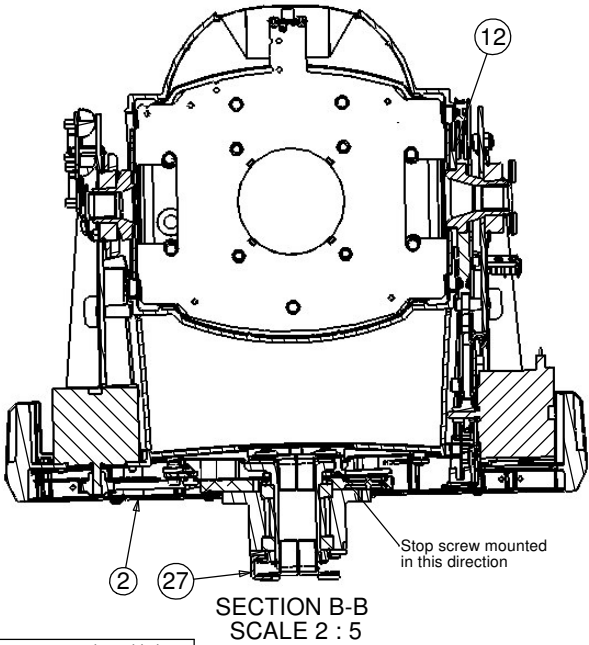
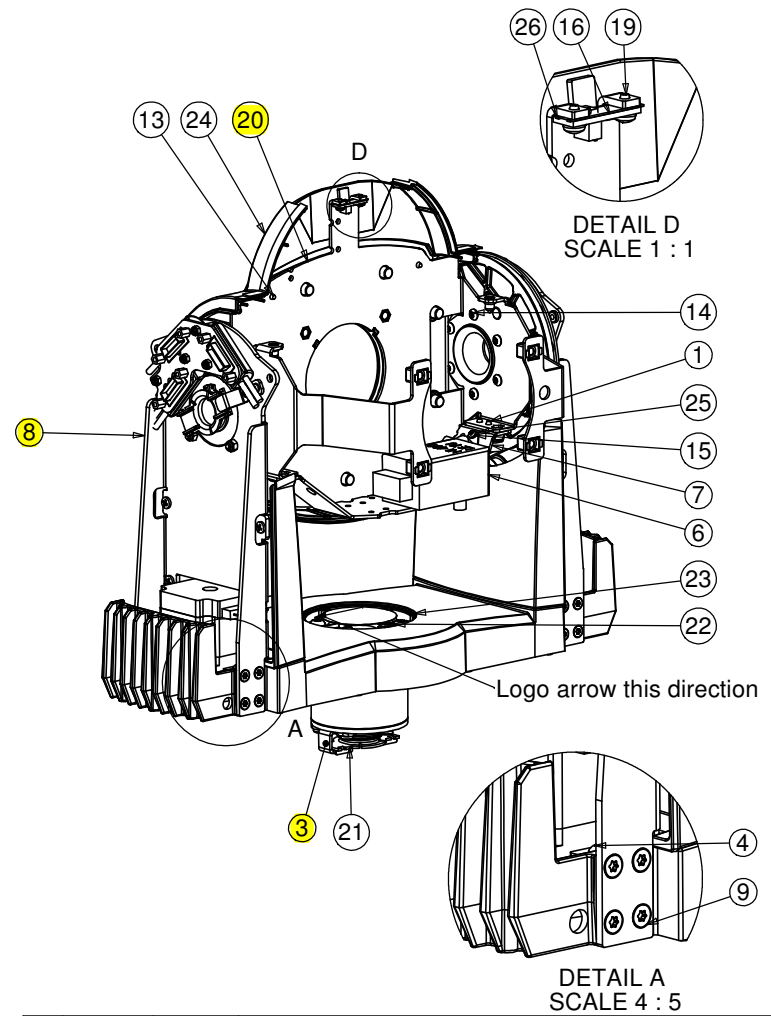
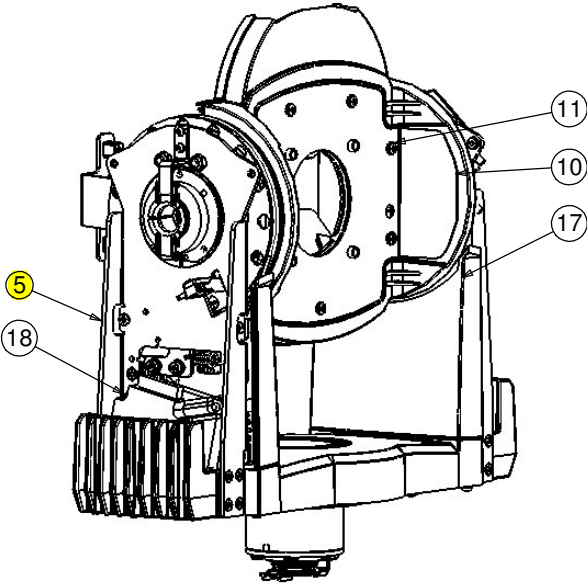

Martin Quality Agreement apply to this item

A	21.12.2007	RD_TSA	First release	
Rev.	Date	Resp.	CO no. / Comment	
Martin		First used in MAC 200	Material	
Item to be			General linear tolerance	
Item to be			General angular tolerance	
Item to be	Color		Format A2	Scale 1:5
			Unit mm	
Description (Model in view 55231004 Yoke)			Item no.-Rev. 55231004 Yoke	

ITEM NO.	PART NUMBER	DESCRIPTION	QTY.
1	16000520-A	Timing wheel S3M z=24 for tacho	1
2	18400030-B	Optical encoder wheel	1

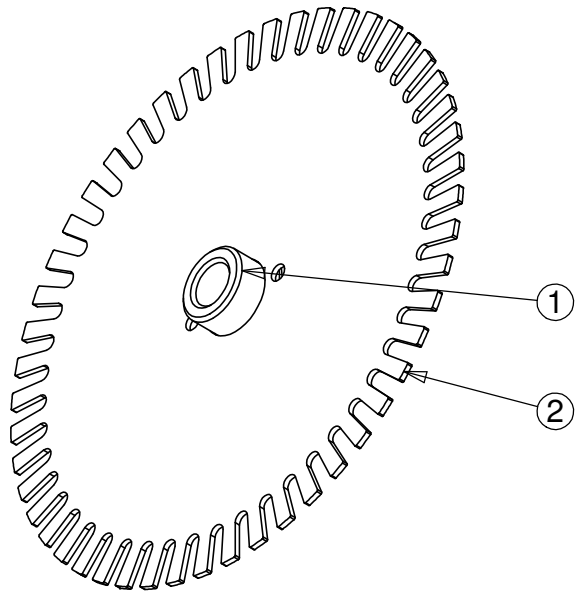

A	09.02.2007	rdtsa		First Release					
Rev.	Date	Resp.	CO no. / Comment						
Martin			First used in MAC 200				Material		
Item to be						General linear tolerance			
Item to be						General angular tolerance			
Item to be					Color		Format A4	Scale 1:1	Unit mm
Description (Model in view 62324080-A)							Item no.-Rev.		
Pulley z=24 w. tacho, glued							62324080-A		

ITEM NO.	PART NUMBER	DESCRIPTION	QTY.
1	08073601-A	M4 rivet nut cs splined 1-3mm	2
2	23817480-C	Censor Bracket	1

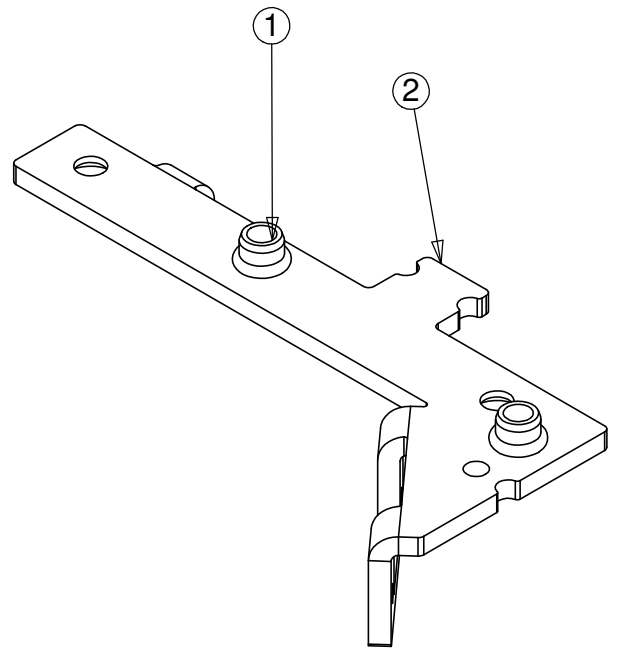

A	21.12.2007	RD_TSA	First release
Rev.	Date	Resp.	CO no. / Comment
Martin		First used in MAC 200	Material
Item to be			General linear tolerance
Item to be			General angular tolerance
Item to be		Color	Format A4
			Scale 1:1
			Unit mm
Description (Model in view 62406088-A)			Item no.-Rev.
Censor Bracket			62406088-A

Martin Quality Agreement apply to this item

ITEM NO.	PART NUMBER	DESCRIPTION	QTY.
1	16900290-B	Shaft for pan	1
2	08230109-A	ø30 shaft retaining ring raw	1
3	08331019-A	Special nut M30x1,5	1
4	16760180-A	Bearing 61906-ZZ 30x47x9	2
5	17800540-A	Spacer bearing/timing wheel	1
6	17800640-A	Bearing Spacer D37 d30 L25,5	1
7	23813210-C	Spacer for pan timing wheel	1
8	08131207-A	M8x8 ch allen low raw	1
9	16920310-B	Bearing retainer plate	1
10	08070414-A	M4x50 ph pz black	6
11	18020350-B	Pan stop arm	1
12	16000500-A	Toothwheel, Alu. S3M, z=134	1
13	08111226-A	M6x8 ch allen low black	1
14	16920360-C	Bearing housing PAN	1
15	23818670-A	Wire leading clip	1

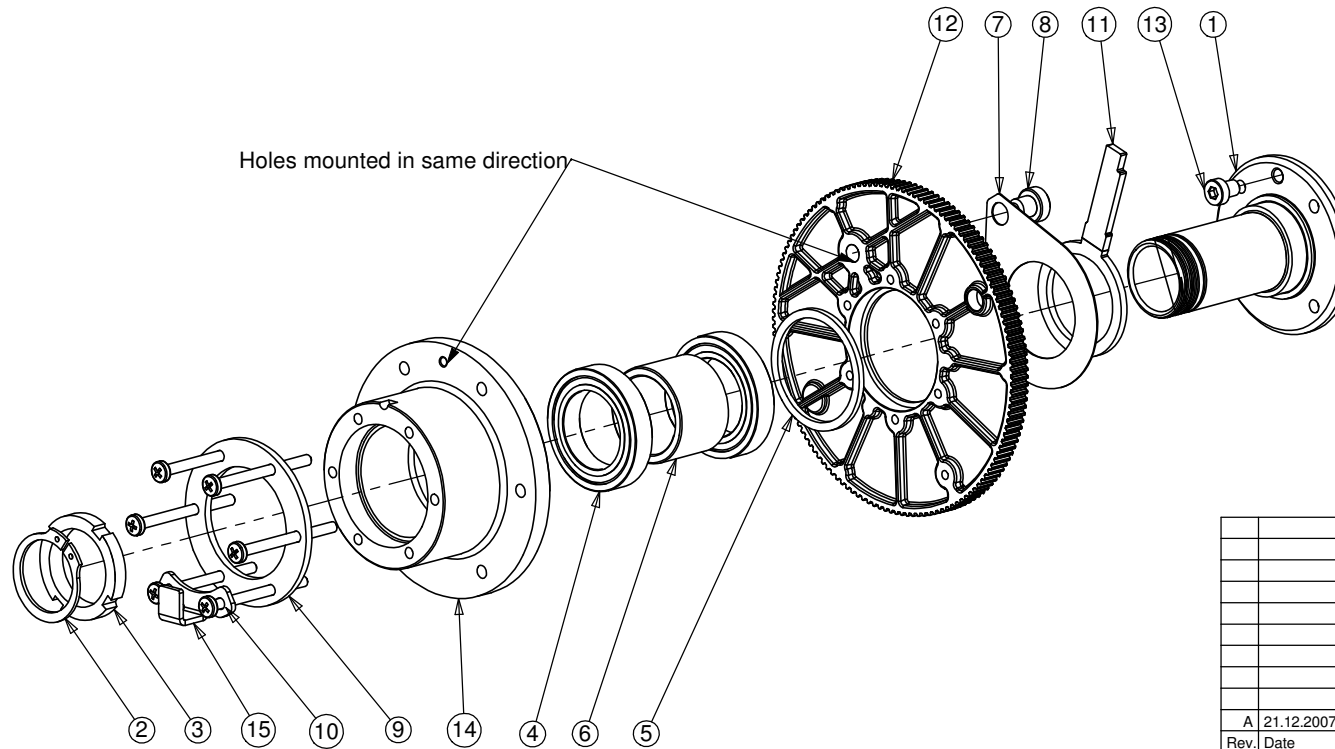
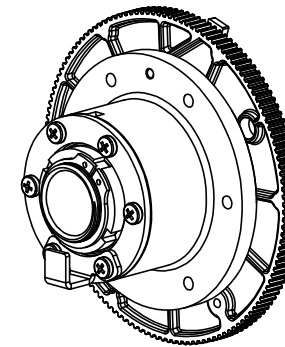

A	21.12.2007	RD TSA	First release		
Rev.	Date	Resp.	CO no. / Comment		
Martin		First used in MAC 200	Material		
Item to be		General linear tolerance			
Item to be		General angular tolerance			
Item to be		Color	Format A3	Scale 1:2	Unit mm
Description (Model in view 62406087-A)				Item no.-Rev.	
Pan bearing asm				62406087-A	

ITEM NO.	PART NUMBER	DESCRIPTION	QTY.
1	16760090-A	Bearing 6005-ZZN 25X47X12	1
2	62406096-A	Tilt motor asm	1
3	16920170-C	Yoke Distanceplate	1
4	08111201-A	M6x10 ch allen low black	2
5	16920110-E	Bearing retainer plate	1
6	13201010-A	Protector for wires PT.M250-2K	1
7	08230104-A	ø25 shaft retaining ring raw	1
8	23817460-B	Yoke Cable Clip Plate	1
9	08112701-A	M6 nut lock PA shiny	2
10	08070805-A	M4x8 cs torx tapt spikes black	3
11	08050700-A	M3x6 ph torx tapt spike black	2
12	62406093-D	Yoke Chassis Tilt Motor side	1
13	62406094-A	Toothwheel w. flange asm	1
14	08200124-A	TC1 2,9x9,5 ph torx black	2
15	08070709-A	M4x10 bh torx black	4
16	05520506-A	MicroSW 5A/250v Wide arm U.ben	1

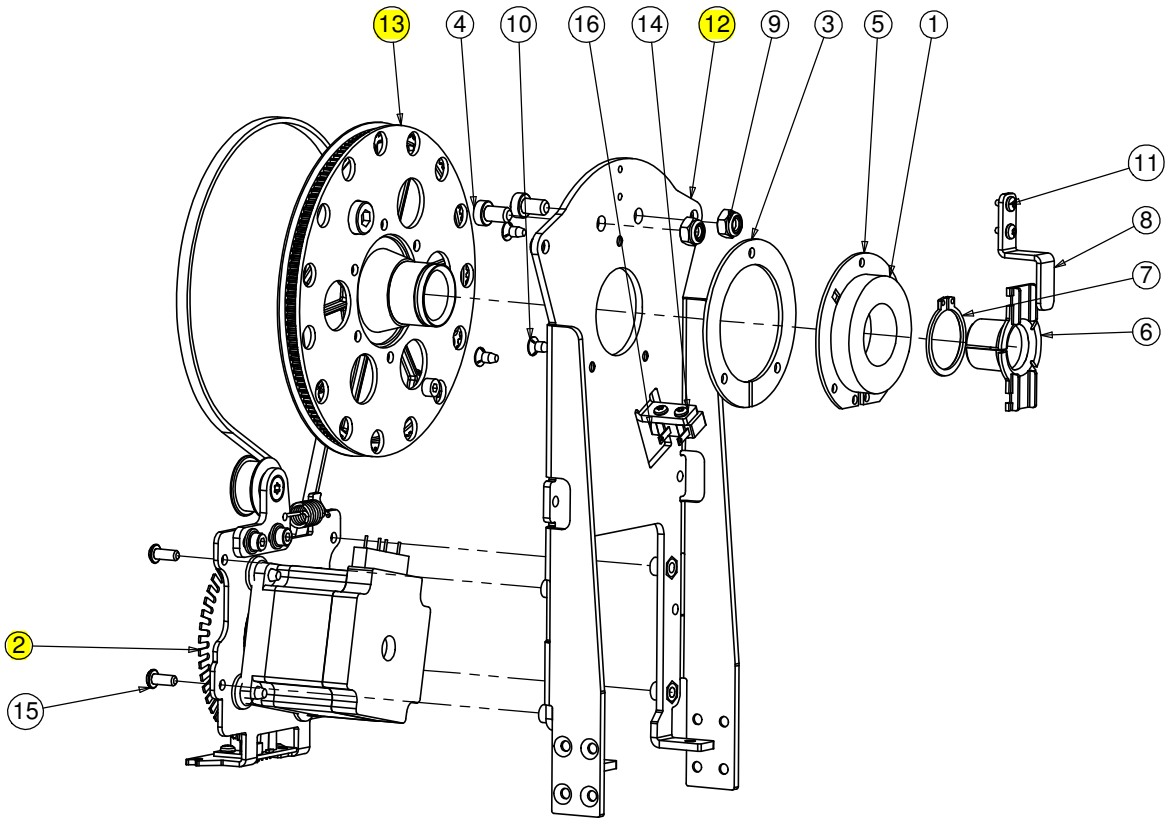
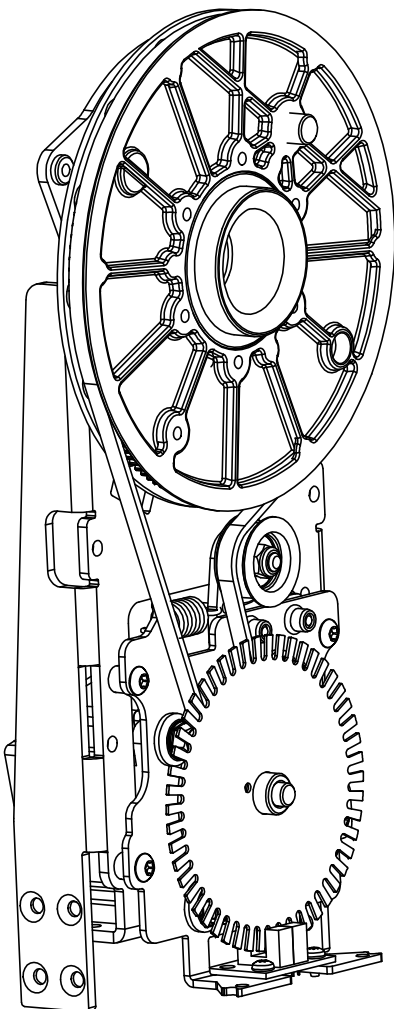

A	10.01.2007	rdtsa	First Release			
Rev.	Date	Resp.	CO no. / Comment			
Martin	First used in MAC 200		Material			
Item to be			General linear tolerance			
Item to be			General angular tolerance			
Item to be		Color		Format A2	Scale 1:2	Unit mm
Description (Model in view 62406085-A)			Item no.-Rev.			
Yokearm tilt motor side			62406085-A			

Martin Quality Agreement apply to this item

ITEM NO.	PART NUMBER	DESCRIPTION	QTY.
1	05701804-A	Stepmotor 23HS1001-22	1
2	13200007-A	Rubber grommet DA 60/90/20	4
3	08091005-A	M5x16 hex cap tapt black	4
4	17800270-A	Spacer $\phi 5,15/\phi 6,1 \times 7$	4
5	08094301-A	M5 Washer, shiny	2
6	16760030-B	Bearing 625-ZZ 5X16X5	1
7	08230501-A	16mm bore retaining ring	1
8	16000410-B	Belt Tightener	1
9	08090804-A	M5x16 UH, Torx 25, DIN963 shiny	1
10	08071212-A	M4x12 ch allen black	2
11	08074303-A	M4 washer 4,3/10x1,25 shiny	2
12	62003040-A	PCB duo optical sensor 5mm	1
13	62324080-A	Pulley z=24 w. tacho, glued	1
14	16040590-A	Timing belt S3M564-5	1
15	08092701-A	M5 Hex lock nut PA-insert	1
16	23817450-E	Tension Pulley Plate	1
17	62406095-B	Tilt motor plate asm.	1
18	08050710-A	M3x5 ph torx tapt black	2
19	17740080-C	10/1,2x27 nt=7 tension spring	1

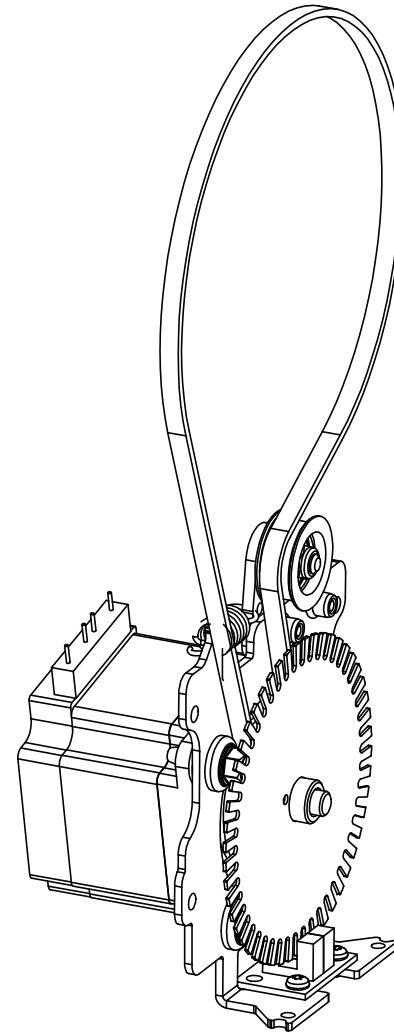
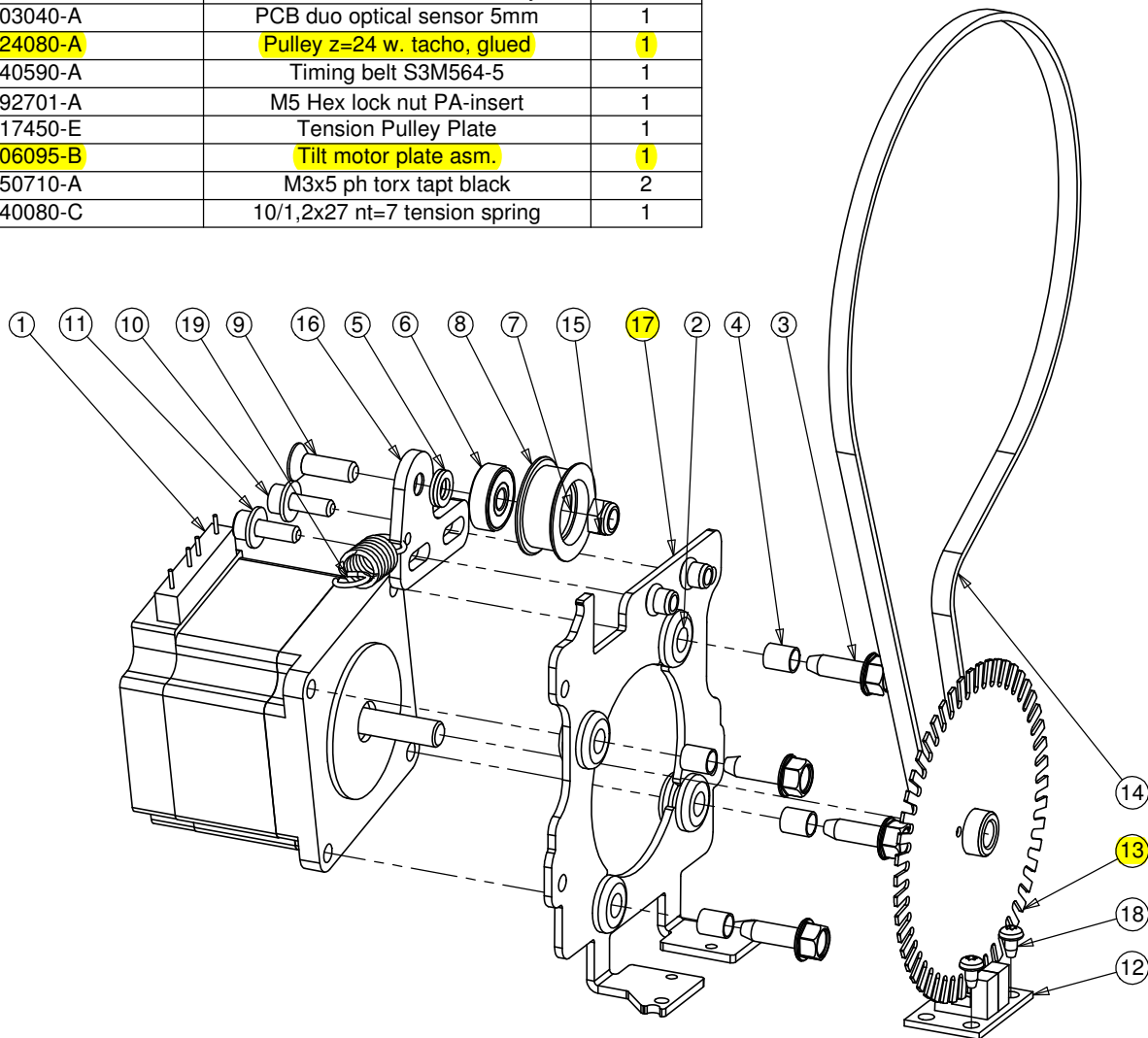

A 07.02.2007 rdtsa First Release		
Rev. Date	Resp.	CO no. / Comment
Martin First used in MAC 200		Material
Item to be		General linear tolerance
Item to be		General angular tolerance
Item to be	Color	Format Scale Unit A3 1:5 mm
Description (Model in view 62406096-A)		Item no.-Rev.
Tilt motor asm		62406096-A

ITEM NO.	PART NUMBER	DESCRIPTION	QTY.
1	16000520-A	Timing wheel S3M z=24 for tacho	1
2	18400030-B	Optical encoder wheel	1

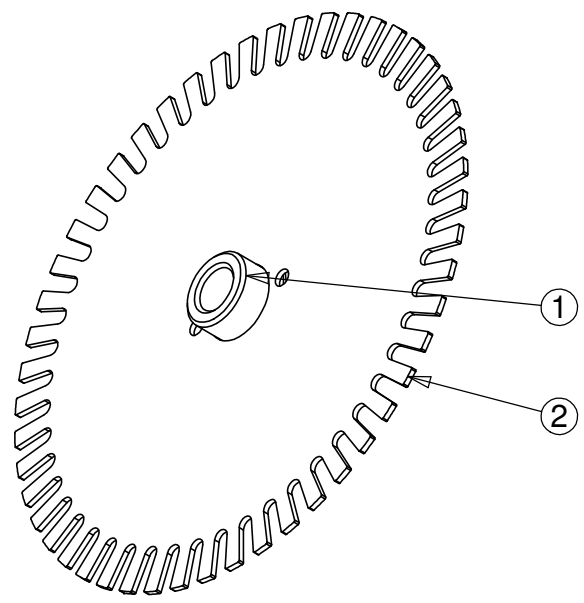

Rev.	Date	Resp.	CO no. / Comment																			
A	09.02.2007	rdtsa	First Release																			
<table border="1"> <tr> <td rowspan="2"> Martin First used in MAC 200 </td> <td colspan="3">Material</td> </tr> <tr> <td colspan="3">General linear tolerance</td> </tr> <tr> <td colspan="2">Item to be</td> <td colspan="2">General angular tolerance</td> </tr> <tr> <td>Item to be</td> <td>Color</td> <td>Format A4</td> <td>Scale 1:1 Unit mm</td> </tr> <tr> <td colspan="3">Description (Model in view 62324080-A) Pulley z=24 w. tacho, glued</td> <td>Item no.-Rev. 62324080-A</td> </tr> </table>				Martin First used in MAC 200	Material			General linear tolerance			Item to be		General angular tolerance		Item to be	Color	Format A4	Scale 1:1 Unit mm	Description (Model in view 62324080-A) Pulley z=24 w. tacho, glued			Item no.-Rev. 62324080-A
Martin First used in MAC 200	Material																					
	General linear tolerance																					
Item to be		General angular tolerance																				
Item to be	Color	Format A4	Scale 1:1 Unit mm																			
Description (Model in view 62324080-A) Pulley z=24 w. tacho, glued			Item no.-Rev. 62324080-A																			

ITEM NO.	PART NUMBER	DESCRIPTION	QTY.
1	08073601-A	M4 rivet nut cs splined 1-3mm	2
2	23817440-F	Tilt motor plate	1

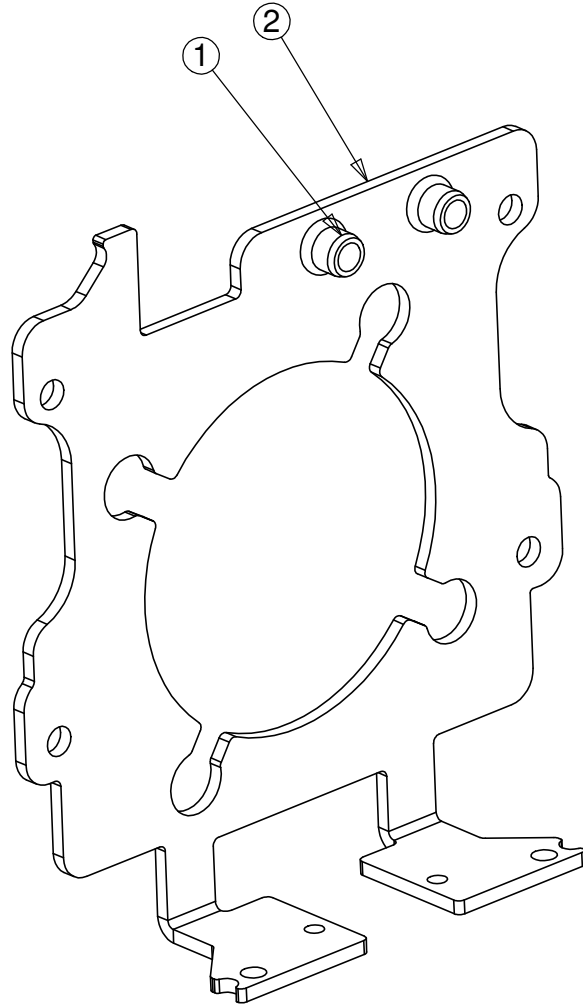

B	17.08.2007	rdtsa	Metal part changed		
A	01.02.2007	rdtsa	First Release		
Rev.	Date	Resp.	CO no. / Comment		
Martin		First used in MAC 200		Material	
Item to be				General linear tolerance	
Item to be				General angular tolerance	
Item to be			Color	Format A4	Scale 1:1 Unit mm
Description (Model in view 62406095-B) Tilt motor plate asm.				Item no.-Rev. 62406095-B	

ITEM NO.	PART NUMBER	DESCRIPTION	QTY.
1	08073705-A	PEM SO-M4-8 ZI Standoff	4
2	08073702-A	PEM S-M4-1-ZI	2
3	23817410-F	Yoke Chassis Motor side	1

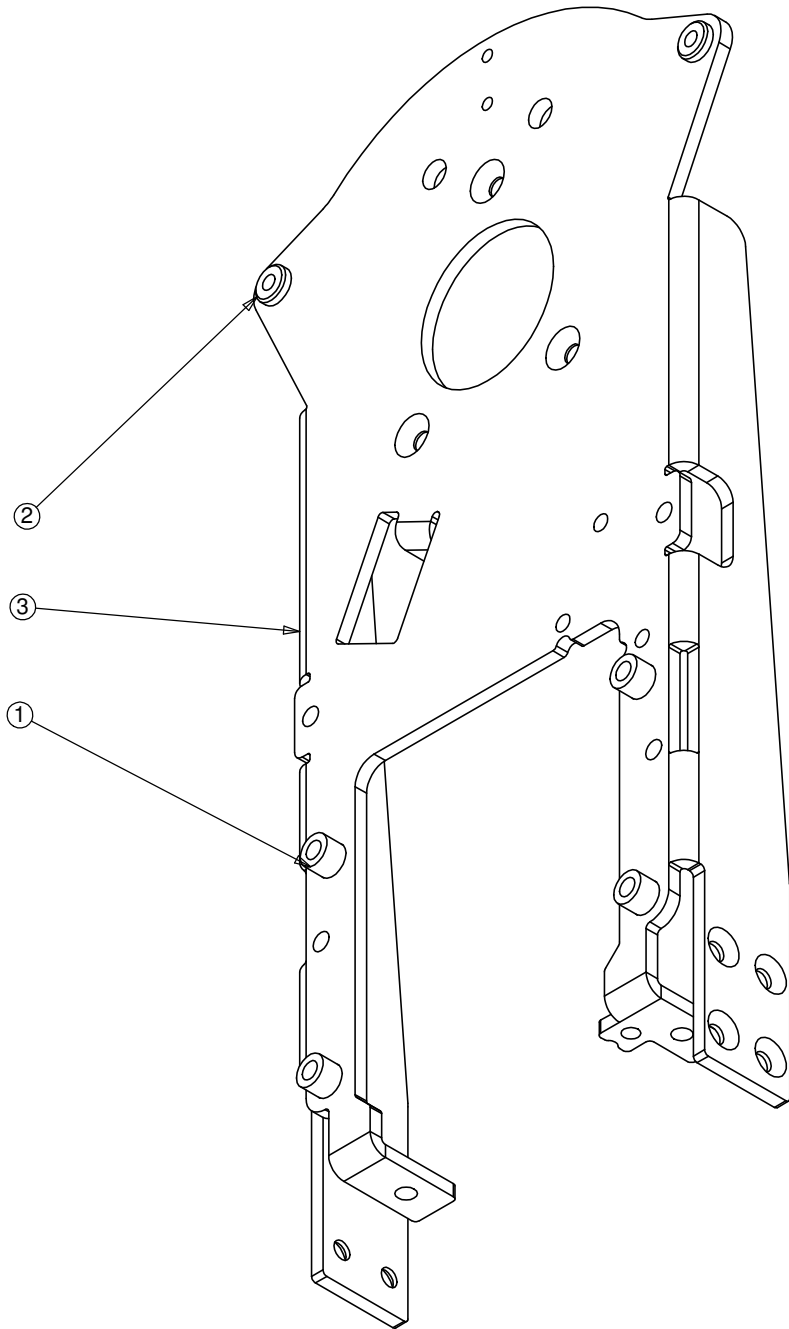

D	12.12.2007	rdtsa	BOM update
C	03.10.2007	rdtsa	Assembly update
B	04.09.2007	rdtsa	Assembly update
A	31.01.2007	rdtsa	First Release
Rev.	Date	Resp.	CO no. / Comment
Martin		First used in MAC 200	Material
Item to be		General linear tolerance	
Item to be		General angular tolerance	
Item to be		Color	Format Scale Unit A3 1:1 mm
Description (Model in view 62406093-D)			Item no.-Rev.
Yoke Chassis Tlit Motor side			62406093-D

ITEM NO.	PART NUMBER	DESCRIPTION	QTY.
1	16760090-B	Bearing 6005-ZZN 25X47X12	1
2	16920210-A	Bearing retainer plate	1
3	08230104-A	ø25 shaft retaining ring raw	1
4	08072701-A	M4 nut lock PA shiny	3
5	08050700-A	M3x6 ph torx tapt spike black	2
6	17820650-A	Spacer plate tilt bearing	1
7	08071206-A	M4x16 ch allen black	3
8	08052701	M3 lock nut	4
9	23817430-D	Connector Plate	1
10	11860201-C	Wireset "2", TW1 cmy module	3
11	08053810-A	M3x12 stand off m6/f7 black	4
12	08053806-A	M3x7 spacer m/f black	6
13	08050702-A	M3x6 ph torx black	3
14	16900160-C	Adaptor for ball bearing MAC250 series	1
15	62406092-B	Yoke_Chassis PCB Side	1
16	23817710-D	Yoke Cable Clip Plate	1
17	16900150-G	Bearing adaptor, tilt MAC200 Yoke	1
18	13201010-B	Shaft for wireset pan	1

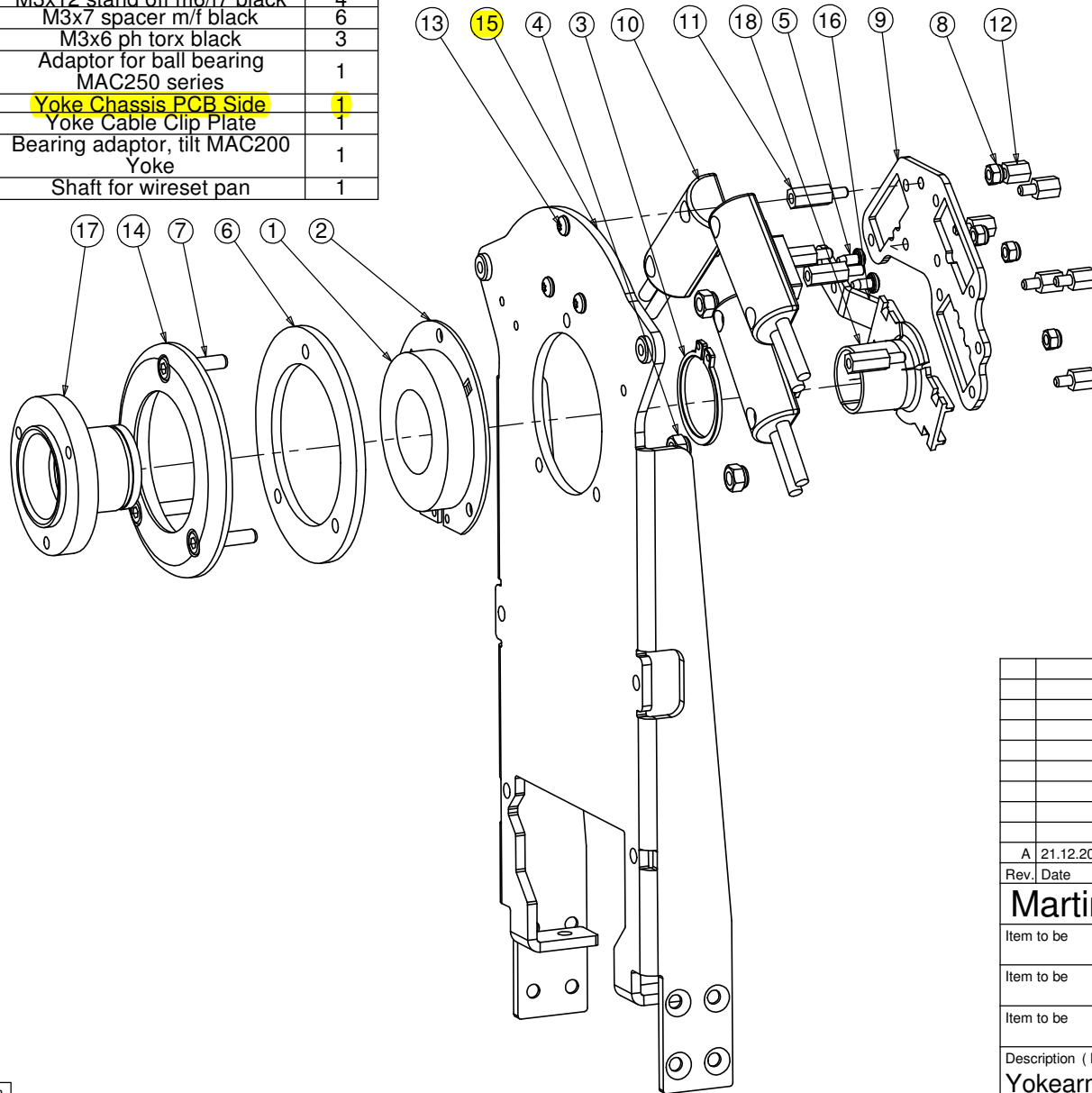

A	21.12.2007	RD_TSA	First release		
Rev.	Date	Resp.	CO no. / Comment		
Martin		First used in MAC 200	Material		
Item to be		General linear tolerance			
Item to be		General angular tolerance			
Item to be		Color	Format A2	Scale 1:2	Unit mm
Description (Model in view 62406086-A)			Item no.-Rev.		
Yokearm PCB side			62406086-A		

ITEM NO.	PART NUMBER	DESCRIPTION	QTY.
1	08073702-A	PEM S-M4-1-ZI	2
2	23817420-E	Yoke Chassis PCB side	1

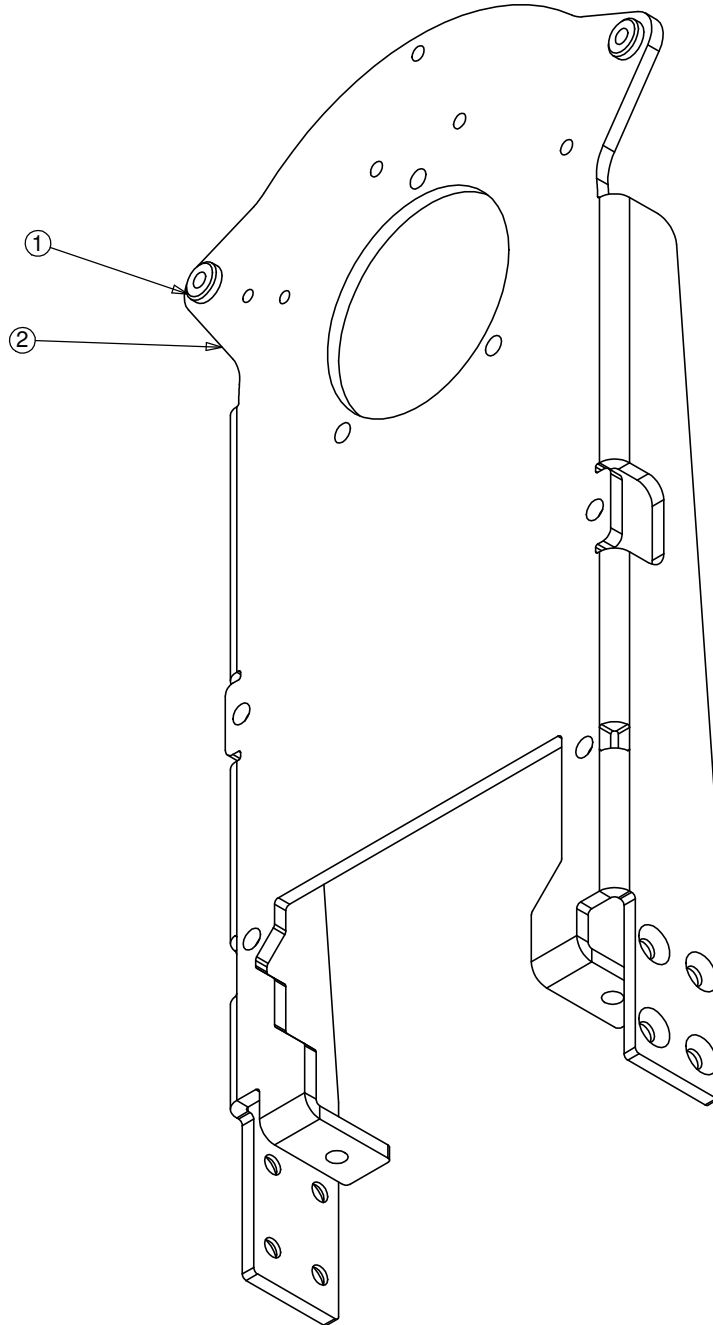

B	04.09.2007	rdtsa	Assembly update		
A	31.01.2007	rdtsa	First Release		
Rev.	Date	Resp.	CO no. / Comment		
Martin		First used in MAC 200		Material	
Item to be		General linear tolerance			
Item to be		General angular tolerance			
Item to be		Color		Format A3	Scale 1:1
Item to be		Unit mm			
Description (Model in view 62406092-B)				Item no.-Rev.	
Yoke Chassis PCB Side				62406092-B	

ITEM NO.	PART NUMBER	DESCRIPTION	QTY.
1	08093700-A	PEM SO-85.1-12 ZI	4
2	08073601-A	M4 rivet nut cs splined 1-3mm	2
3	08240127-A	1/4 turn receptacle 4mm	4
4	23817390-E	Main Head Chassis	1

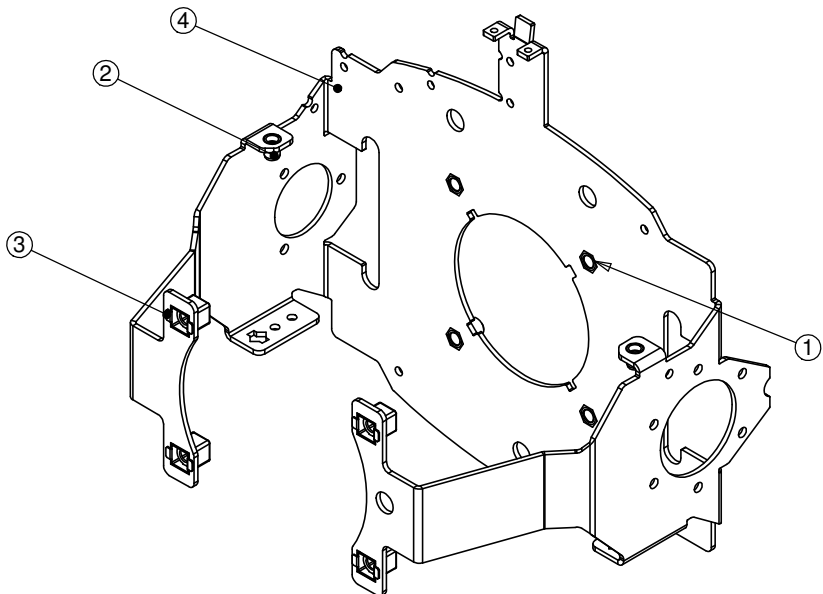

B	05.09.2007	mssck	Assembly update		
A	19.02.2007	rdtsa	First Release		
Rev.	Date	Resp.	CO no. / Comment		
Martin		First used in MAC 200	Material		
Item to be		General linear tolerance			
Item to be		General angular tolerance			
Item to be	Color		Format A3	Scale 1:5	Unit mm
Description (Model in view 62400584-B)				Item no.-Rev.	
Head Chassis asm				62400584-B	

Martin Quality Agreement apply to this item

ITEM NO.	PART NUMBER	DESCRIPTION	QTY.
1	62406083-A	Lamp adjustment asm	1
2	08050709-A	M3x10 ph torx black	4
3	08050703-A	M3x8 ph torx black	2
4	23817570-B	Lock plate for reflector	1
5	18860030-D	Head lampcooling	2
6	20800190-A	Light obstruct	1
7	08070710-A	M4x12 bh torx black	4
8	97010118-A	Lamp HSD 150/2 Industrial P.	1
9	41002096-A	D75 Reflector cup hard coating	1
10	62406081-B	Filter holder asm	1

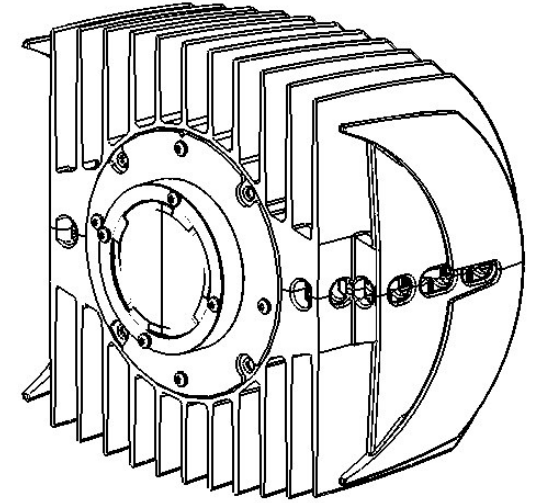
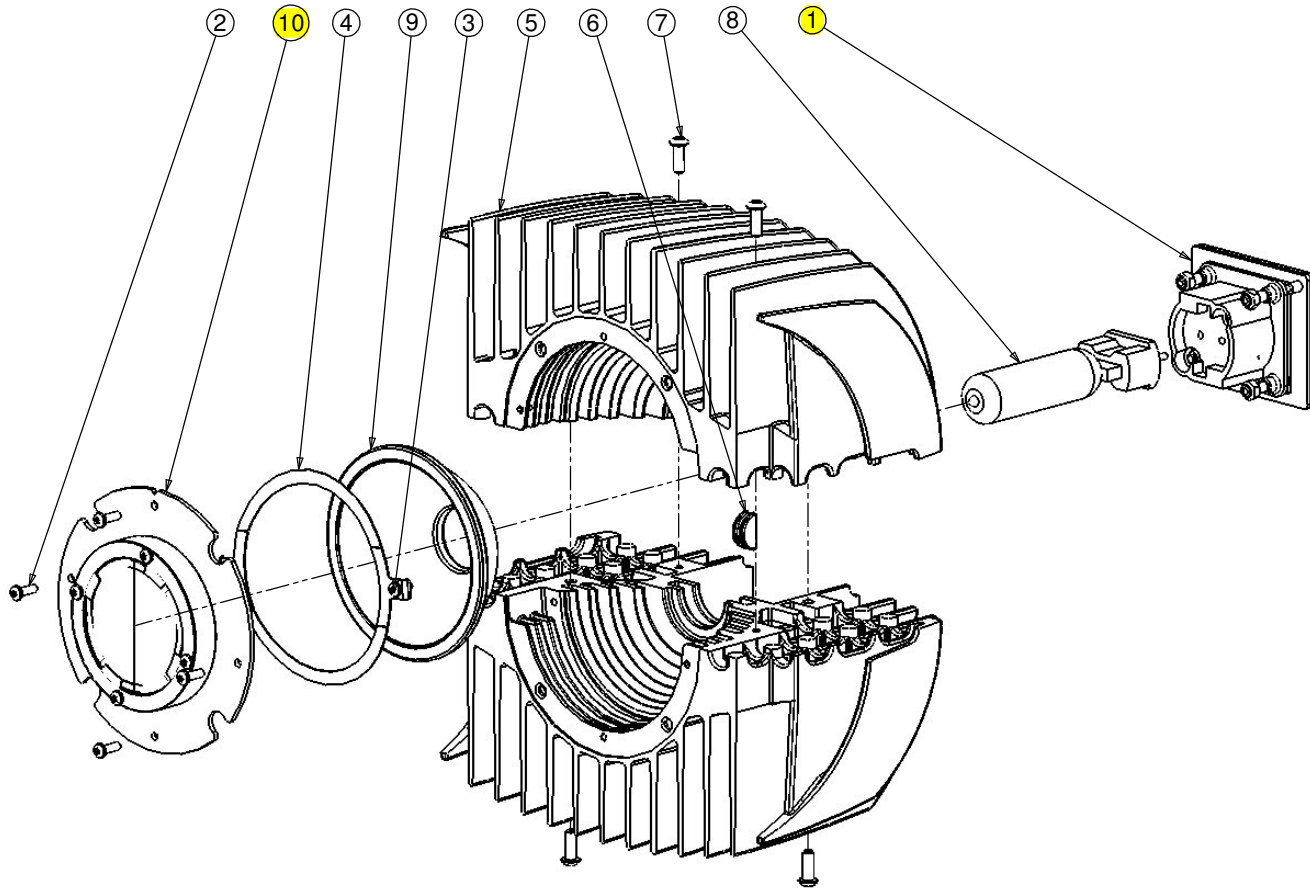

A	03.03.2007	rdtsa	First release		
Rev.	Date	Resp.	CO no. / Comment		
Martin		First used in MAC 200	Material		
Item to be		General linear tolerance			
Item to be		General angular tolerance			
Item to be		Color	Format A2	Scale 1:1	Unit mm
Description (Model in view 55231001 Head cooling)			Item no.-Rev.		
Cooling lamp section			55231001 Head		

ITEM NO.	PART NUMBER	DESCRIPTION	Default/QTY
1	62406082-B	Lamp adjust socket asm	1
2	23903240-B	Lamp adjust backplate asm	1
3	17780110-E	Spring for lampadjustment	1
4	05221207-a	Socket G12, 350mm wire	1
5	08071207-A	M4x25 ch allen black	3
6	08220101-A	3.2x6 Pop Rivet Black	2
7	08050507-A	M3x20 cs pz black	2
8	08054401-A	M3 lock washer 3,2/6 black	2
9	08052601-A	M3 nut black	2
10	20200780-D	Lamp wire retainer	1
11	08050801-A	M3x12 cs torx black	2
12	20600570-A	Lamp socket stuffing	1
13	05348407-A	Cable plug 6.3mm male,3.3mm hole	1
14	08072702-A	M4 lock nut DIN980V shiny	3
15	08070709-A	M4x10 bh torx black	2
16	08074402	M4 vistop push-on washer shiny	2

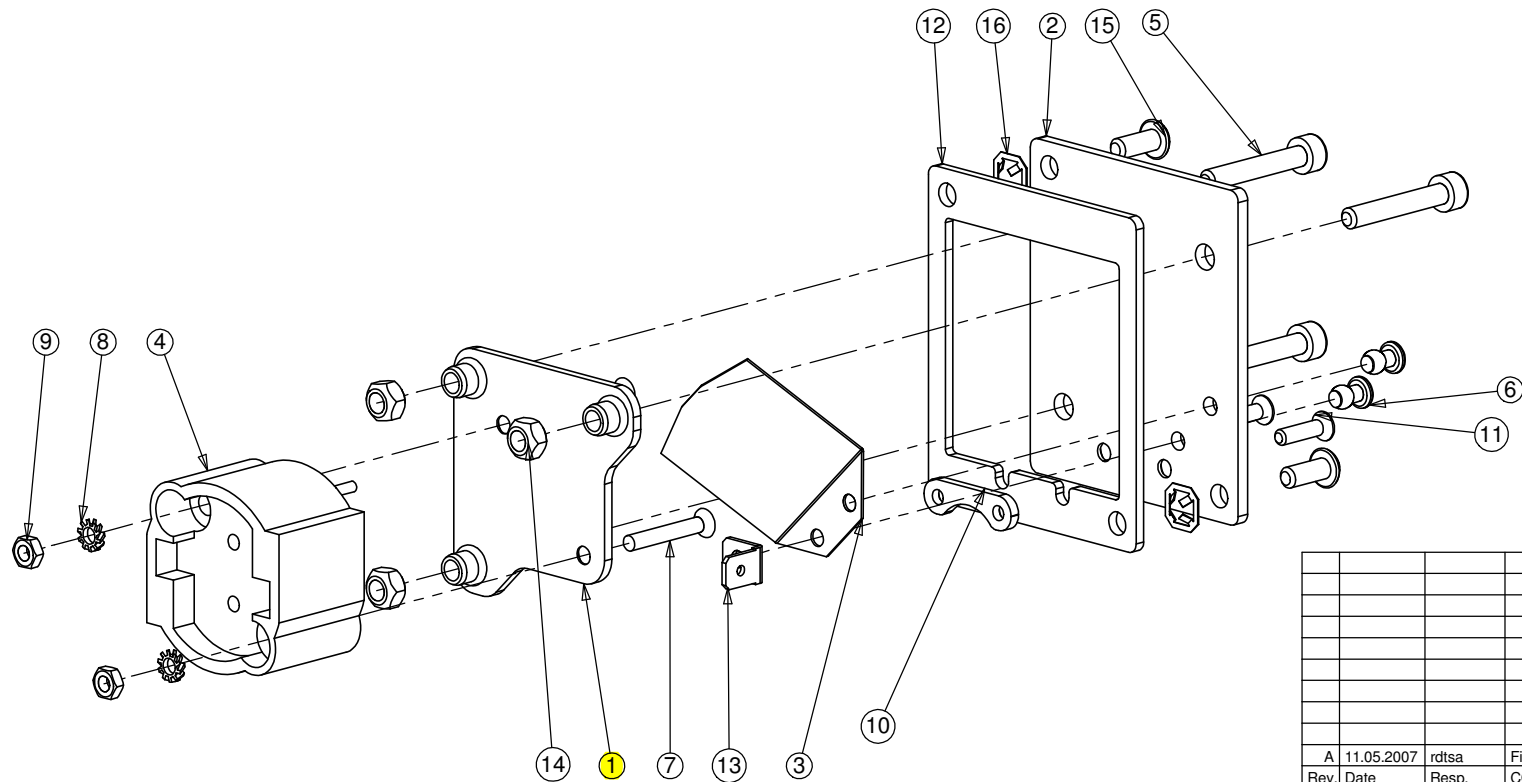
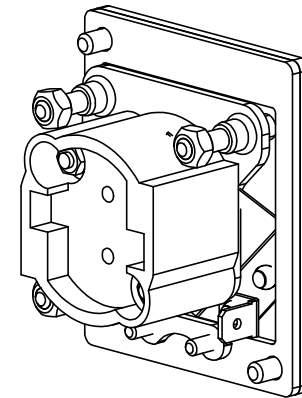
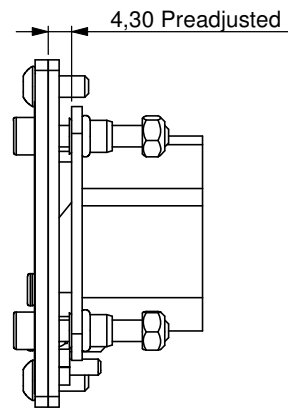

Rev.	Date	Resp.	CO no. / Comment		
A	11.05.2007	rdtsa	First release		
Item to be		Material			
Item to be		General linear tolerance			
Item to be		General angular tolerance			
Item to be		Color	Format	Scale	Unit
			A3	1:1	mm
Description (Model in view 62406083-A)				Item no.-Rev.	
Lamp adjustment asm				62406083-A	

ITEM NO.	PART NUMBER	DESCRIPTION	QTY.
1	08073601-A	M4 rivet nut cs splined 1-3mm	3
2	20200710-E	Lamp adjust socket	1

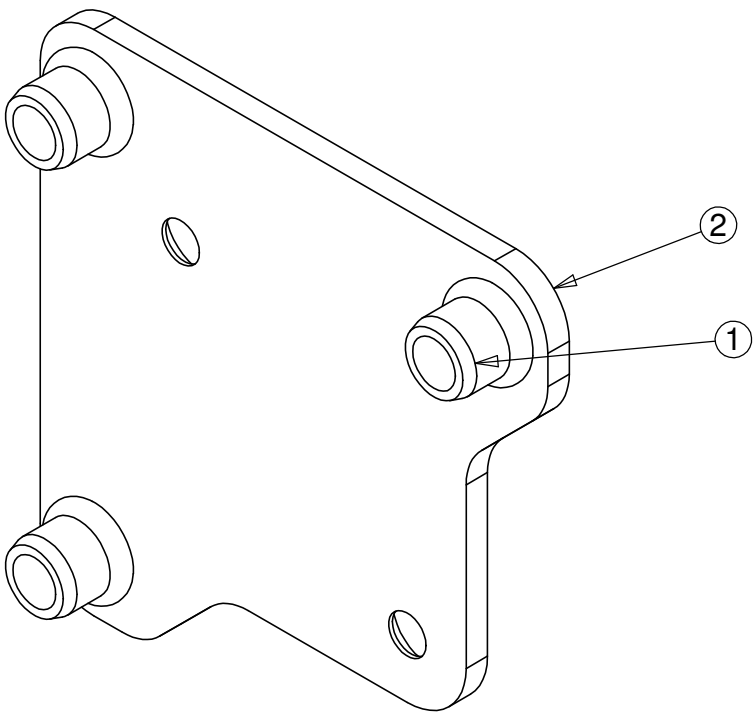

Rev.	Date	Resp.	CO no. / Comment
B	12.09.2007	rdtsa	Assembly update
A	12.07.2007	rdtsa	First release

Martin	First used in MAC 200	Material
---------------	--------------------------	----------

Item to be	General linear tolerance
------------	--------------------------

Item to be	General angular tolerance
------------	---------------------------

Item to be	Color	Format A4	Scale 2:1	Unit mm
------------	-------	--------------	--------------	------------

Description (Model in view 62406082-B)	Item no.-Rev.
Lamp adjust socket asm	62406082-B

Martin Quality Agreement apply to this item

ITEM NO.	PART NUMBER	DESCRIPTION	QTY.
1	41102074-A	Ø51 Heat filter Schott	1
2	23817590-B	Plate for light pipe	1
3	17201050-B	Filter holder	1
4	08050702-A	M3x6 ph torx black	8
5	17760490-B	Filter spring	1
6	41600062-B	Diffuser Ø55	2

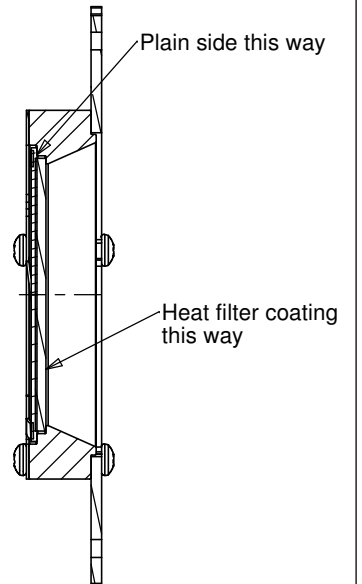
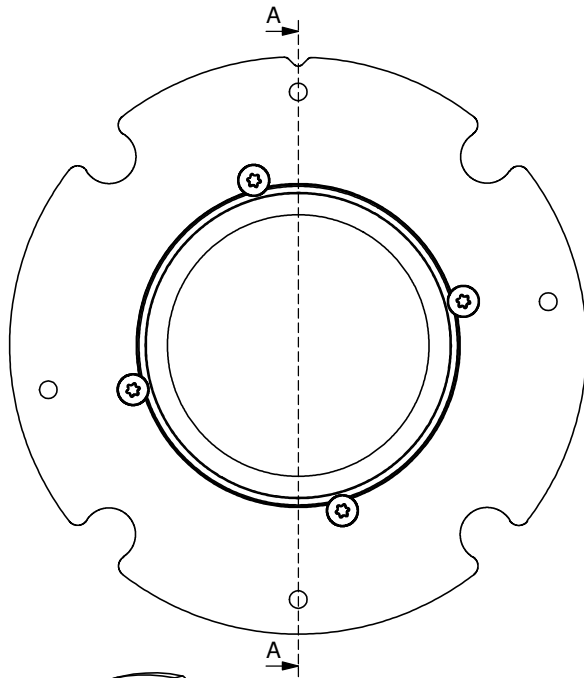

SECTION A-A

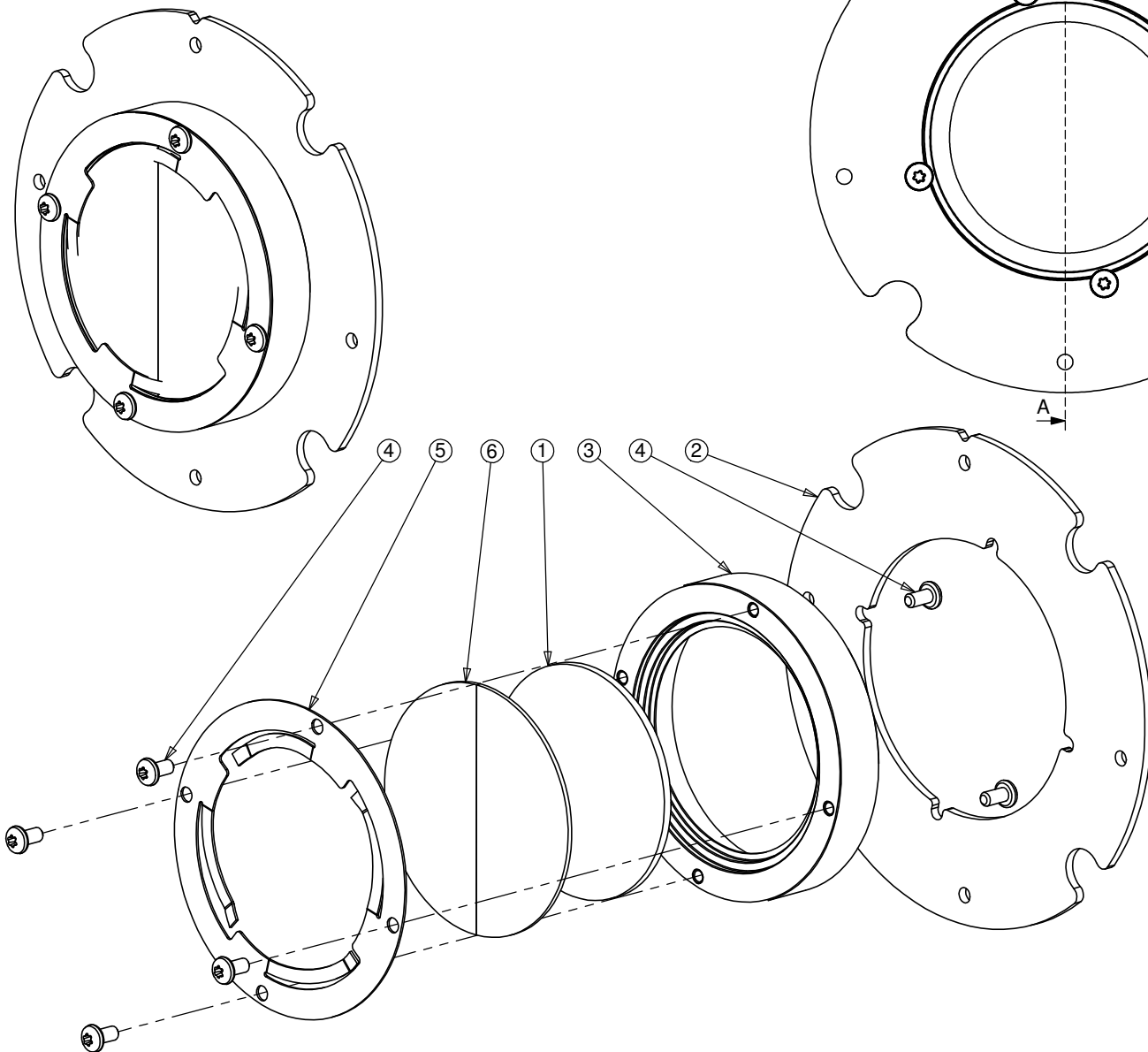

B	10.01.2008	rdtsa	BOM update		
A	11.05.2007	rdtsa	First release		
Rev.	Date	Resp.	CO no. / Comment		
Martin	First used in MAC 200			Material	
Item to be				General linear tolerance	
Item to be				General angular tolerance	
Item to be			Color	Format A3	Scale 1:1
Description (Model in view 62406081-B)				Unit mm	Item no.-Rev.
Filter holder asm				62406081-B	

Martin Quality Agreement apply to this item

ITEM NO.	PART NUMBER	DESCRIPTION	QTY.
1	16040430-A(1)	Timing belt, T2,5-177,5-04 CF	1
2	08114302-A	M6 Washer Stainless steel	1
3	08114314-A	Shim washer 6/12x0,5 black	4
4	08114408-A	Wave washer 6,2/9,7x1,5 s=0,1	1
5	62406089-A	Focus Lens asm	1
6	62406091-A	Shutter asm	1
7	62406090-B	Effect-zoom asm	1
8	16040470-A	Timing belt, T2,5-265-04 CF	1
9	11860204-A	Wireset "1", MAC200 effect module	1
10	11860205-A	Wireset "2", MAC200 effect module	1
11	08053803-A	M3x6 stand off m6/f3 shiny	4
12	62326077-A	Color wheel w. colors, bearing	1
13	08070700-A	M4x6 bh torx black	1
14	62406105-A	Sensor-color asm	1
15	08052601-A	M3 nut black	6
16	08070702-A	M4x6 ph torx tapt spike black	3
17	16040440-A	Timing belt, T2,5-200-04 CF	1
18	62325126-A	Rot gobo wheel with gobos	1

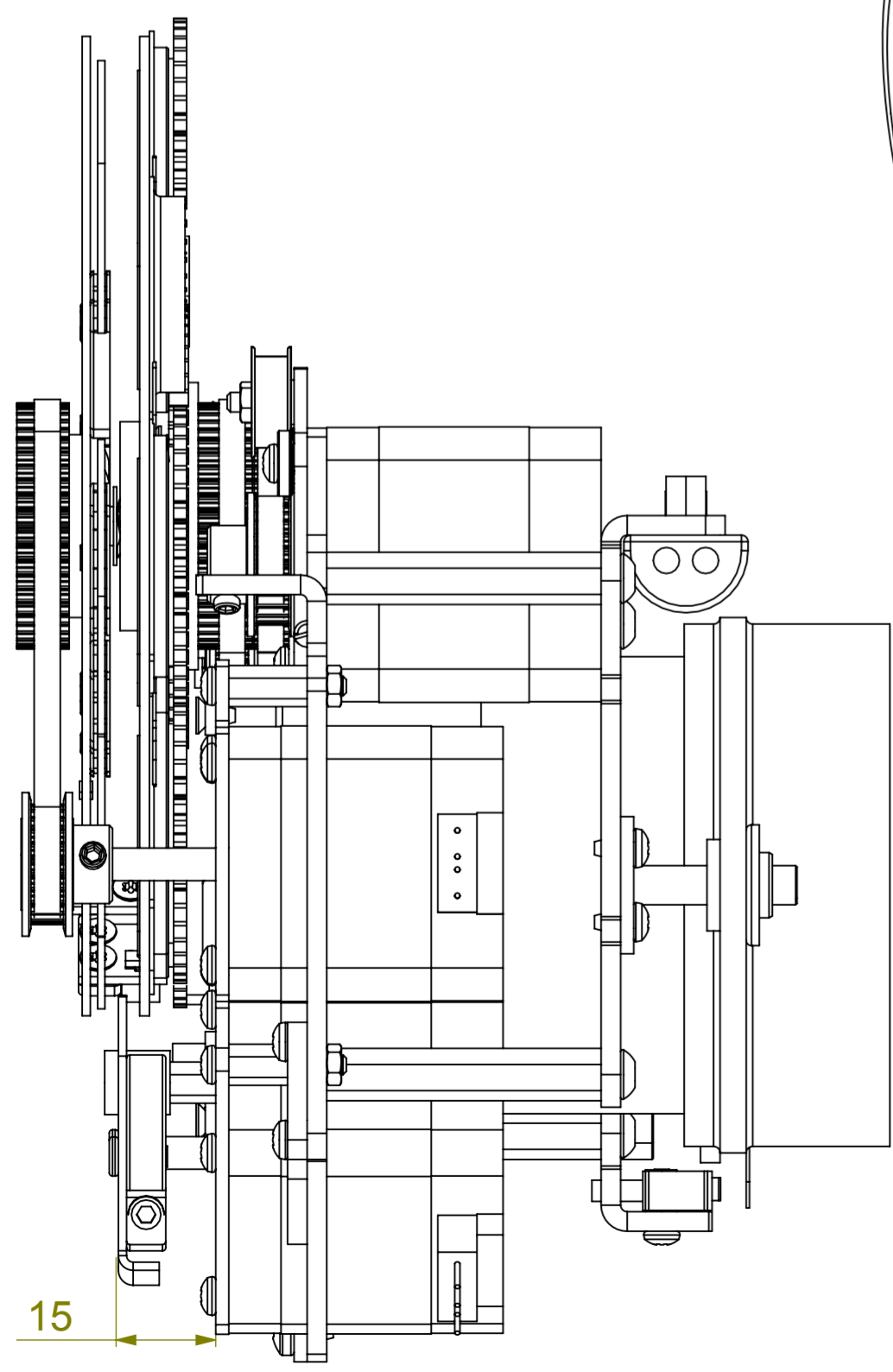
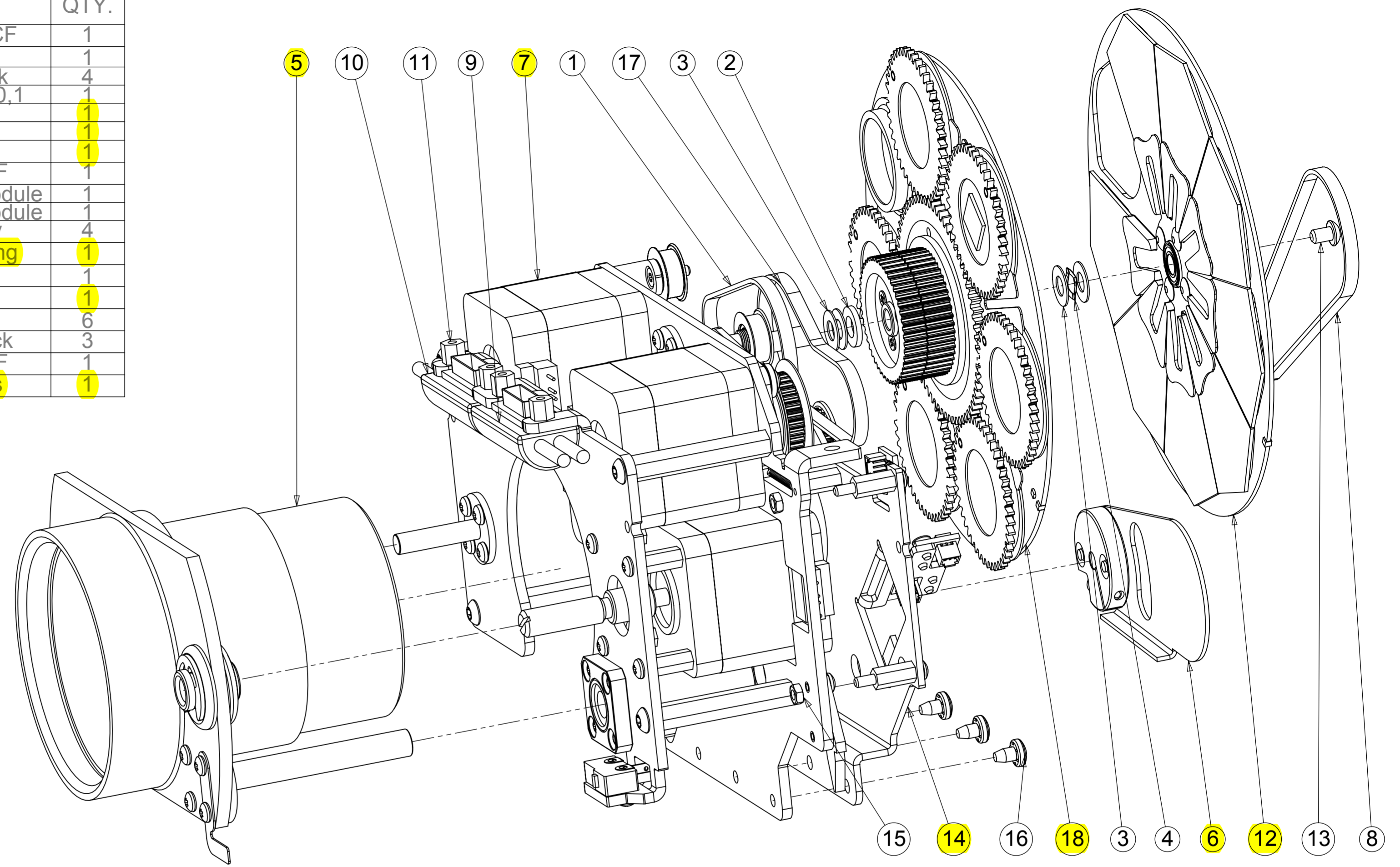

Rev.	Date	Responsible	Comment
A	07.02.2007	rdtsa	First Release
Item to be			Material
Item to be			General linear tolerance
Item to be			General angular tolerance
Item to be			Color
Description (Model in view 55231002 Effect module)			Format A2 Scale 1:5 Unit mm
Effect Module			Item no.-Rev. 55231002 Effect

ITEM NO.	PART NUMBER	DESCRIPTION	QTY.
1	16700320-A	Flange bearing MFM-0610-10	1
2	08230116-A	ø10 shaft retaining ring	1
3	16720590-A	Zoom axle Ø8	1
4	13200013-A	Rubber Grommet 12/18/4	1
5	08230124-A	Circlip DIN6799 for D15mm axle	2
6	08050703-A	M3x8 ph torx black	4
7	41203017-C	Mac 200 Lens House	1
8	17780770-A	Zoom switch Spring	1
9	16170170-C	Carrier M8x1	1

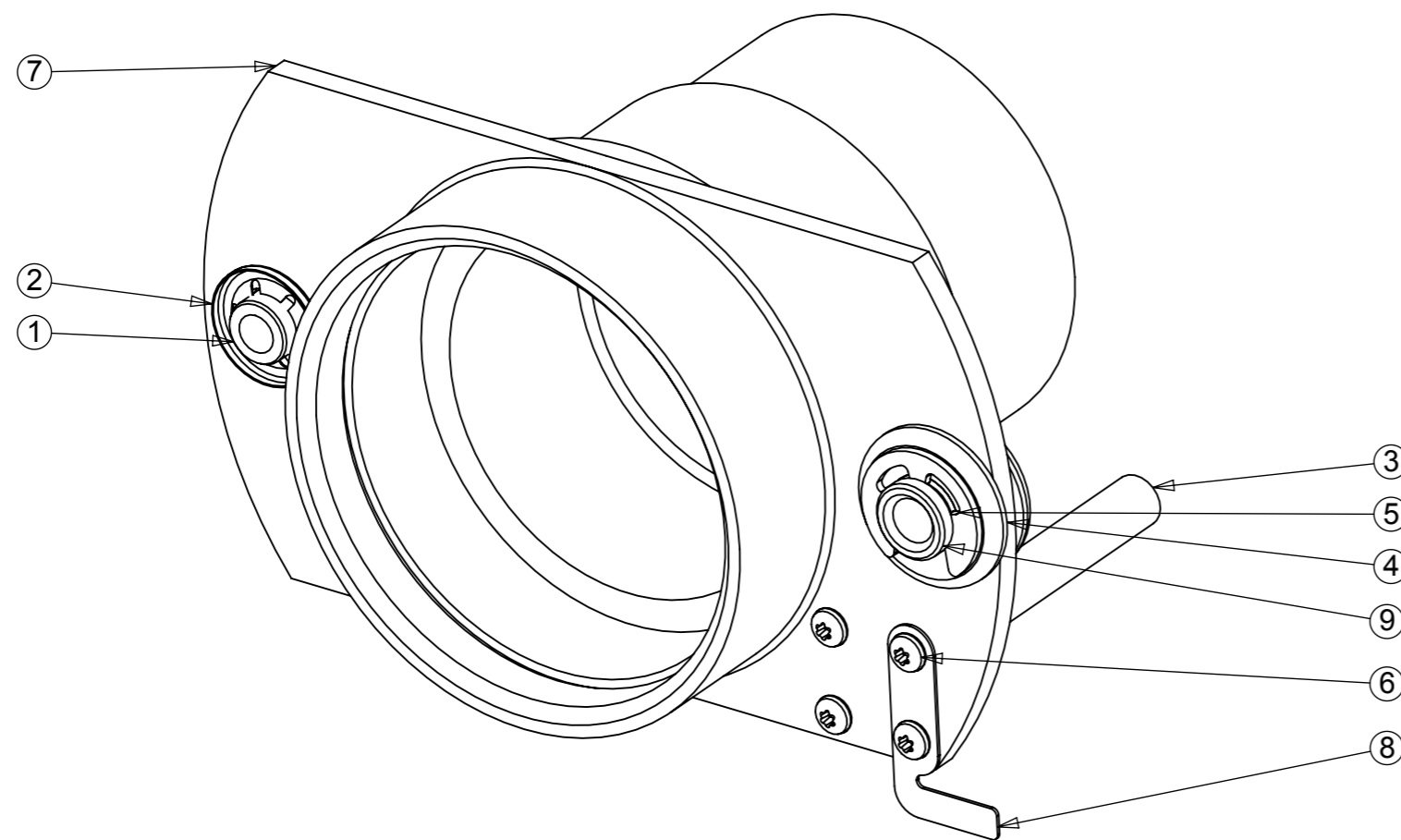

A	07.02.2007	rdtsa	First Release		
Rev.	Date	Resp.	CO no. / Comment		
Martin		First used in MAC 200	Material		
Item to be		General linear tolerance			
Item to be		General angular tolerance			
Item to be		Color	Format A3	Scale 1:2	Unit mm
Description (Model in view 62406089-A)			Item no.-Rev.		
Focus Lens asm			62406089-A		

ITEM NO.	PART NUMBER	DESCRIPTION	QTY.
1	16300410-A	Universal adaptor ø5	1
2	08220102-A	3.2x7.5 Pop Rivet Alu/steel cl	2
3	08051202-A	M3x16 ch allen raw	1
4	17040490-B	Shutter MAC200	1

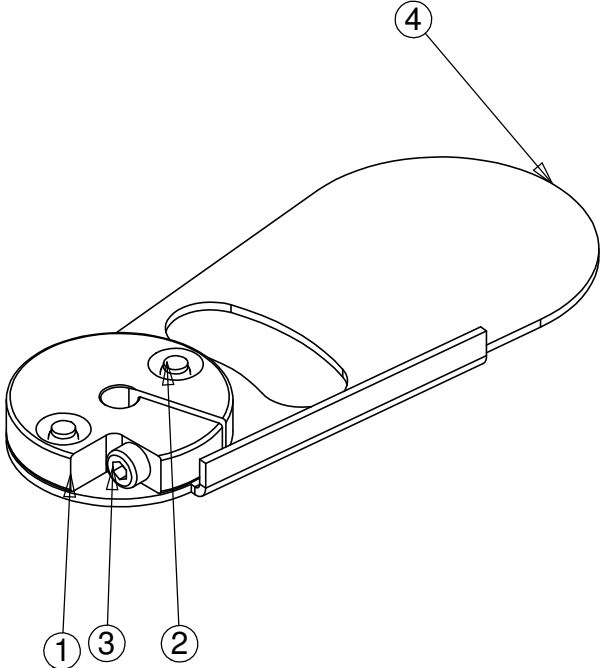

Rev.	Date	Resp.	CO no. / Comment		
A	07.02.2007	rdtsa	First Release		
Martin			First used in MAC 200	Material	
Item to be			General linear tolerance		
Item to be			General angular tolerance		
Item to be			Color	Format A4	Scale 1:1
Item to be			Unit mm		
Description (Model in view 62406091-A)				Item no.-Rev.	
Shutter asm				62406091-A	

Martin Quality Agreement apply to this item

ITEM NO.	PART NUMBER	DESCRIPTION	QTY.
1	23817270-E	Effect Module Plate	1
2	05701613-A	17PM-K105-11VS Short Shaft	3
3	16000510-B	Timing wheel T2,5 z=32 standard	1
4	08073814-A	M4x42 Spacer F/F	6
5	23817280-F	Lens Support	1
6	16000210-D	Timing wheel T2,5 z=24 standard	1
7	16720600-B	Effect Wheel Axle	1
8	17500150-B	Module guide	2
9	05520504-A	Micro switch 5A/250v U.arm	1
10	16720610-A	Zoom Axle Ø6	1
11	16170180-B	Threaded Shaft M8x1	1
12	08053809-A	M3x12 Spacer m/f 4mm shiny	4
13	08070708-A	M4x8 bh torx black	6
14	08200124-A	TC1 2,9x9,5 ph torx black	2
15	08050700-A	M3x6 ph torx tapt spike black	16
16	08070801-A	M4x8 cs torx black	6
17	16800070-A	Linear ball bushing LMEK8LUU-BR	1
18	08050802-A	M3x6 cs torx black	4
19	08050702-A	M3x6 ph torx black	4
20	62406103-A	Tension pulley asm R	1
21	62406104-A	Tension pulley asm L	1
22	16780250-A	Flanged bushing ø6x2,50	2
23	08114408-A	Wave washer 6,2/9,7x1,5 s=0,1	2
24	08050706-A	M3x12 ph torx black	2
25	08050709-A	M3x10 ph torx black	2
26	08054307-A	M3 washer 3,2/9x0,8 black	2
27	17740090-A	4/0,55 l=21,2 n=25 Tens spring	2
28	08071501-A	M4x5 set allen raw	2
29	08051501-A	M3x3 set allen raw	1

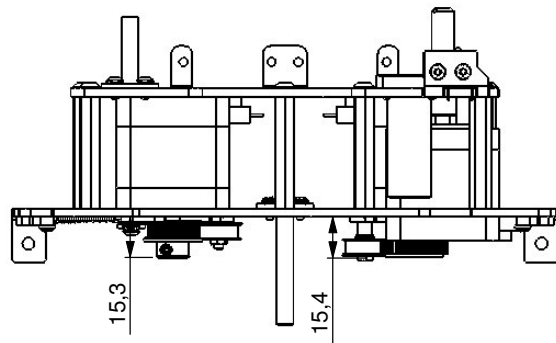
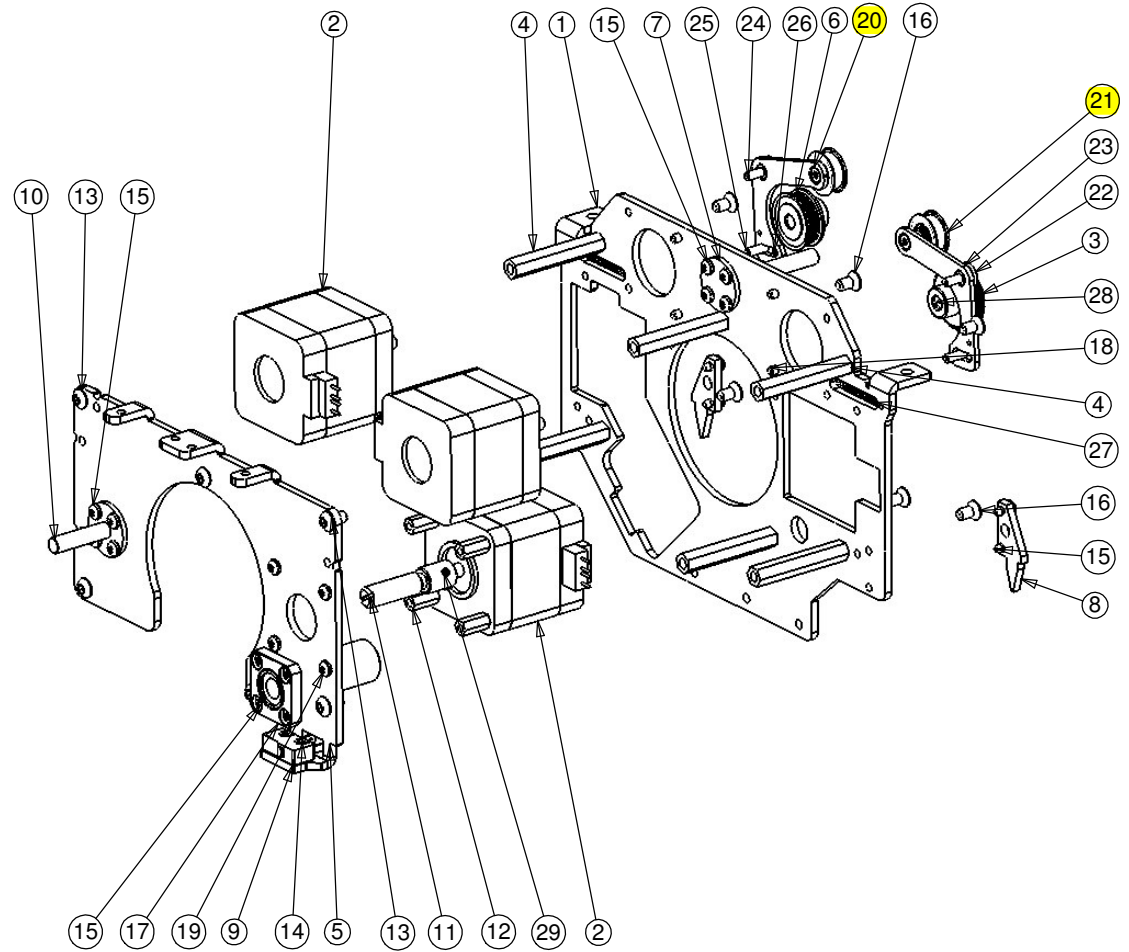

Rev.	Date	Resp.	CO no. / Comment
B	22.06.2007	rdtsa	Update
A	12.03.2007	rdtsa	First release

Martin		First used in	Material
Item to be		General linear tolerance	
Item to be		General angular tolerance	
Item to be	Color	Format A3	Scale 1:5
Description (Model in view 62406090-B)			Unit mm
Effect-zoom asm			Item no.-Rev. 62406090-B

ITEM NO.	PART NUMBER	DESCRIPTION	QTY.
1	62400314-A	Belt pulley ø14x5 with bearing	1
2	08261002-A	3,3/5x5 spacer brass	1
3	08054301-A	M3 washer 3,2/7x0,5 shiny	2
4	08052601-A	M3 nut black	1
5	23817360-C	Tension Pulley Plate R	1
6	08050801-A	M3x12 cs torx black	1

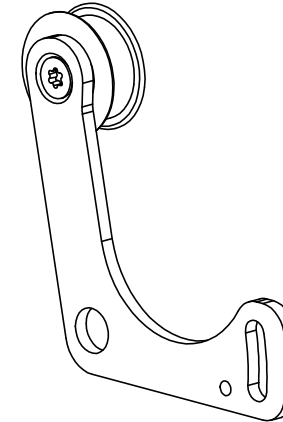
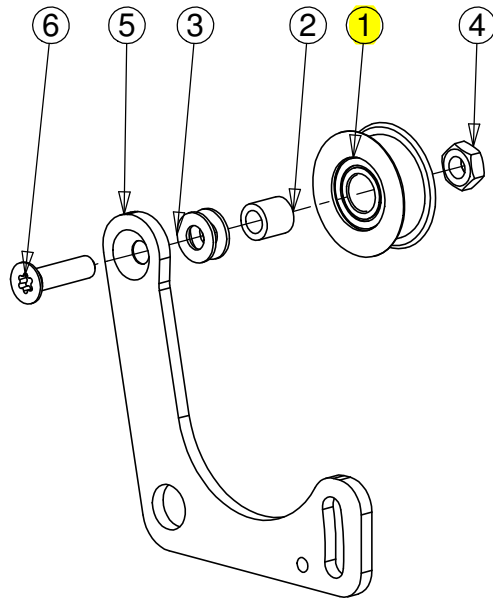

A	22.06.2007	rdtsa	First release							
Rev.	Date	Resp.	CO no. / Comment							
Martin		First used in MAC 200	Material							
Item to be		General linear tolerance								
Item to be		General angular tolerance								
Item to be		Color					Format A4	Scale 1:1	Unit mm	
Description (Model in view 62406103-A)							Item no.-Rev.			
Tension pulley asm R							62406103-A			

ITEM NO.	PART NUMBER	DESCRIPTION	QTY.
1	23817350-C	Tension Pulley Plate R	1
2	62400314-A	Belt pulley $\varnothing 14 \times 5$ with bearing	1
3	08052601-A	M3 nut black	1
4	08261002-A	3,3/5x5 spacer brass	2
5	08050812-A	M3x16 cs torx black	1
6	08054301-A	M3 washer 3,2/7x0,5 shiny	4

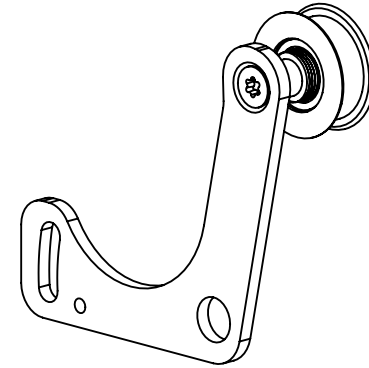
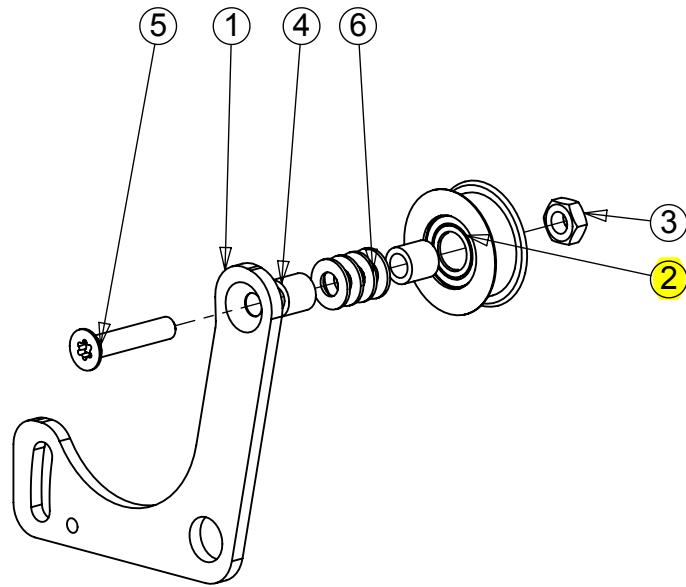

A		22.06.2007	rdtsa	First release
Rev.	Date	Resp.	CO no. / Comment	
Martin			First used in	Material
Item to be				General linear tolerance
Item to be				General angular tolerance
Item to be			Color	Format A4
				Scale 1:1
				Unit mm
Description (Model in view 62406104-A)				Item no.-Rev.
Tension pulley asm L				62406104-A

ITEM NO.	PART NUMBER	DESCRIPTION	QTY.
1	62327198-A	Blue B04-6 SM shp glued	1
	17300020-B	Plastic adaptor for color filter	1
	46404433-B	Blue MAC200 shape B04-6	1
2	62327199-A	Light Green B08-0 SM shp glued	1
	17300020-B	Plastic adaptor for color filter	1
	46404434-B	Light Green MAC200 shape B08-0	1
3	62327201-A	Orange B09-6 SM shp glued	1
	17300020-B	Plastic adaptor for color filter	1
	46404436-B	Orange Mac200 shape B09-6	1
4	62327200-A	Light Yellow B03-1 SM shp glue	1
	17300020-B	Plastic adaptor for color filter	1
	46404435-B	Light Yellow MAC200shape B03-1	1
5	62327196-A	Pink B11-2 SM shp glued	1
	17300020-B	Plastic adaptor for color filter	1
	46404431-B	Pink MAC200 shape B11-2	1
6	62327202-A	Magenta B12 SM shp glued	1
	17300020-B	Plastic adaptor for color filter	1
	46404437-B	Magenta MAC200 shape B12	1
7	62327197-A	Flouroscent B13-1 SM shp glued	1
	17300020-B	Plastic adaptor for color filter	1
	46404432-B	Flouroscent MAC200 shape B13-1	1
8	62327195-A	Dark Red 308 B01-5 SM shp Glued	1
	17300020-B	Plastic adaptor for color filter	1
	46404430-B	Dark Red 308 MAC200shape B01-5	1
9	62326078-A	Colorwheel, 8 colors	1
	17000460-A	Color wheel plate, 8 colors	1
	16000490-A	Timing wheel T2,5-048 (ball bearing)	1
	17820440-C	Spacer plate	1
	16760320-A	Bearing 6/12x4 L-1260ZZ Klüber	2
	08220115-A	Rivet 3,2X13 st/st black 2-10mm	4
	04401102-A	SmCo magnet 2x2x2	1
	17780610-B	Spring clip, color wheel	1

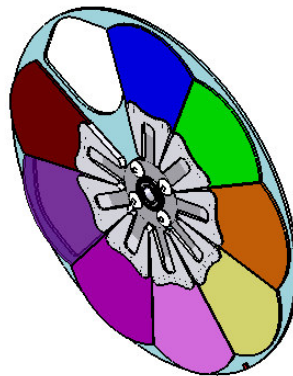
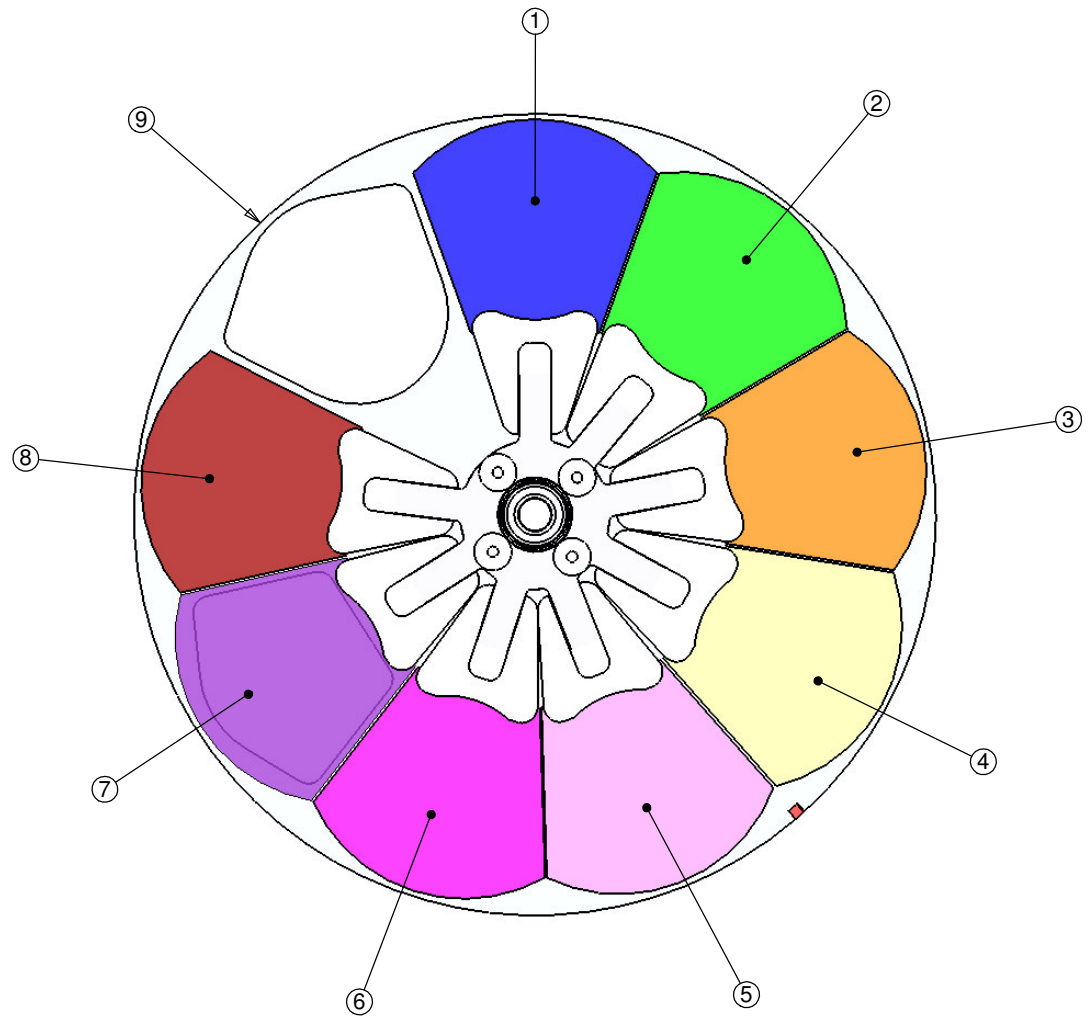

A	11.05.2007	rdtsa	First release				
Rev.	Date	Resp.	CO no. / Comment				
Martin				First used in MAC 200	Material		
Item to be					General linear tolerance		
Item to be					General angular tolerance		
Item to be				Color	Format	Scale	Unit
Description (Model in view 62326077-A)							
Color wheel w. colors, bearing							
						Item no.-Rev.	62326077-A

ITEM NO.	PART NUMBER	DESCRIPTION	QTY.
1	23817640-E	Aparture Plate	1
2	05701613-A	17PM-K105-11VS Short Shaft	1
3	05701612-A	Stepper motor 17PM-K105-09VS	1
4	08050702-A	M3x6 ph torx black	15
5	62090166-A	Hall sensor universal SMD	3
6	08050808-A	M3x6 cs torx tapt black	8
7	62090175-A	Hall sensor universal SMD	1
8	08053829-A	M3x17 spacer f/f black	1
9	62400301-A	Silicone tube D=10, d=5, cutted 10 mm	1
10	16000210-D	Timing wheel T2,5 z=24 standard	1
11	08071501-A	M4x5 set allen raw	1
12	08053810-A	M3x12 stand off m6/f7 black	6

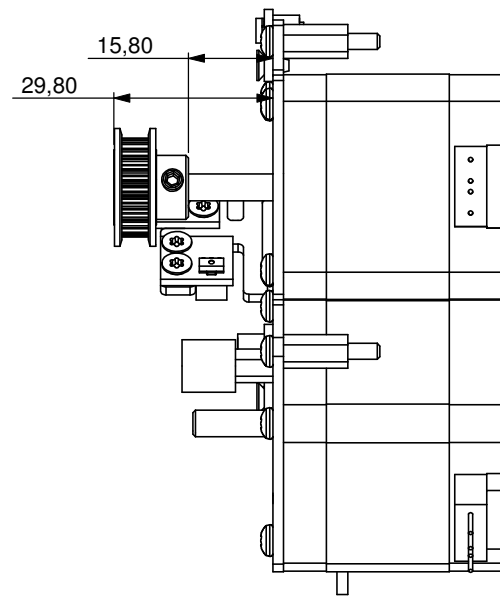
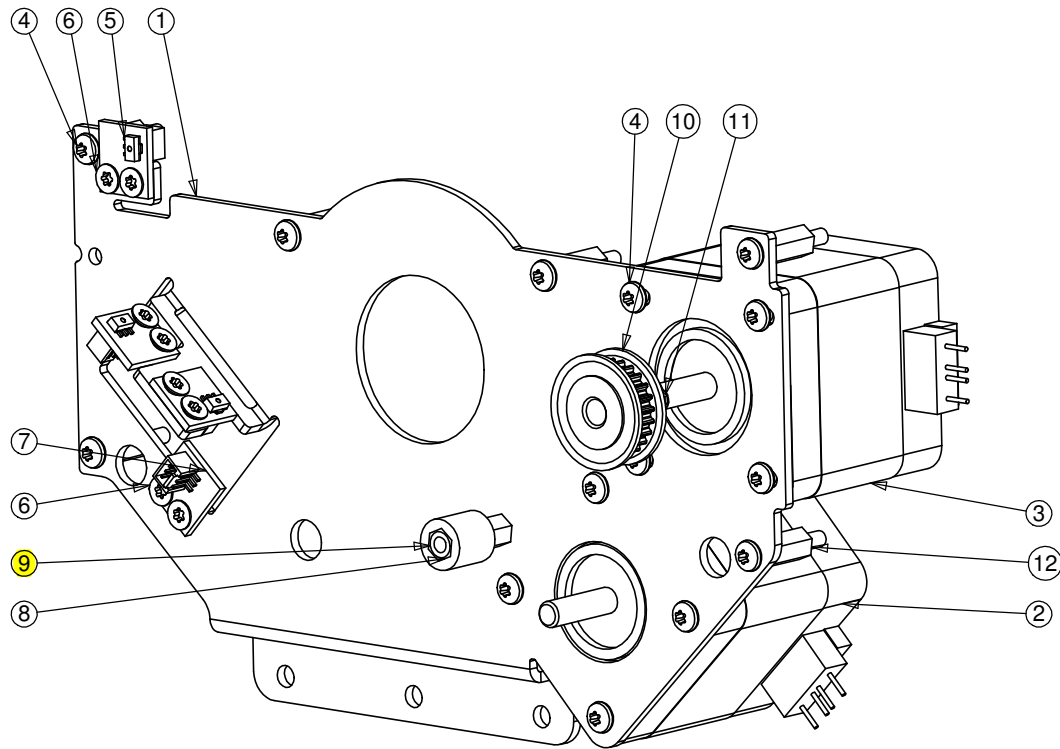

A		22.06.2007	rdtsa	First release
Rev.	Date	Resp.	CO no. / Comment	
Martin			First used in MAC 200	Material
Item to be				General linear tolerance
Item to be				General angular tolerance
Item to be		Color		Format A3
				Scale 1:2
				Unit mm
Description (Model in view 62406105-A)				Item no.-Rev. 62406105-A

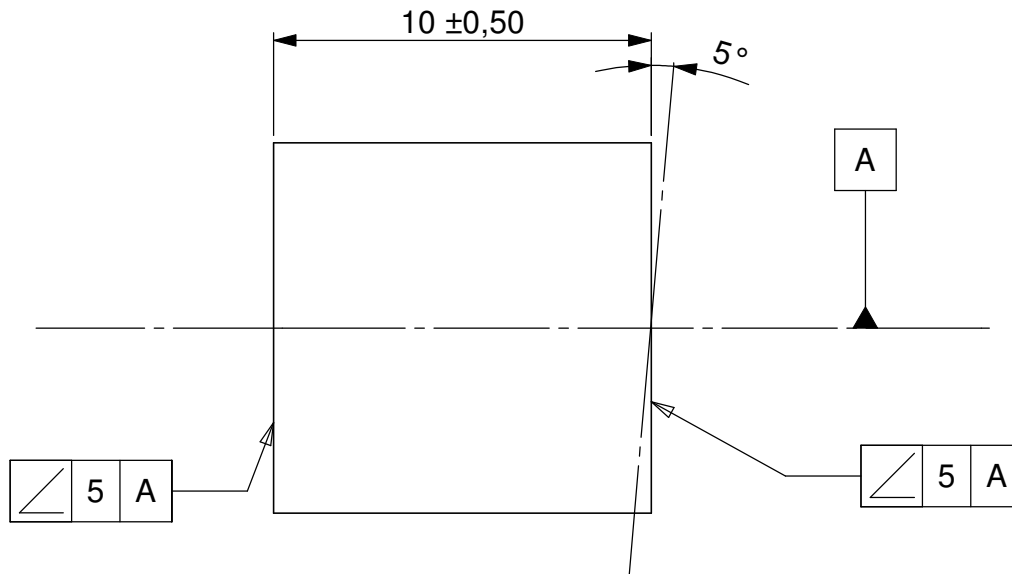
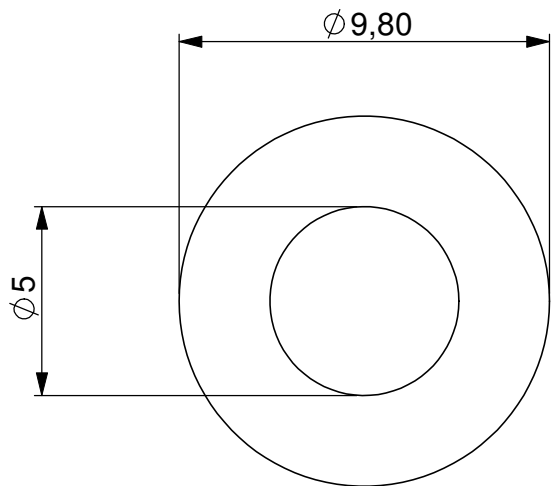

A	21.12.2007	RD_TSA	First released
Rev.	Date	Resp.	CO no. / Comment
Martin		First used in MAC 200	Material Vælg Materiale
Item to be			General linear tolerance ISO 2768-1 c
Item to be			General angular tolerance
Item to be		Color	Format A4
			Scale 5:1
			Unit mm
Description (Model in view 62400301-A)			Item no.-Rev.
Silicone tube D=10, d=5, cutted 10 mm			62400301-A

ITEM NO.	PART NUMBER	DESCRIPTION	QTY.
1	62327146-A	Rot gobo wheel without gobos	1
2	62400284-A	Aperture, rot gobo, painted	1
3	62400319-A	Gobo adaptor with bearing	5
4	62400796-A	Gobo adap. w.bearing, Blue Ripple	1
5	17760380-A	Conical spring, rot gobo	5
6	43076084-A	Gobo smartMAC, Tear Drops paint	1
7	43076085-A	Gobo smartMAC, Fractal painted	1
8	62325127-A	Planets w. cyan 104 glued	1
9	43075021-A	Ovals, smartMAC B/W glass	1
10	43075022-A	Spyrograph smartMAC, B/W glass	1

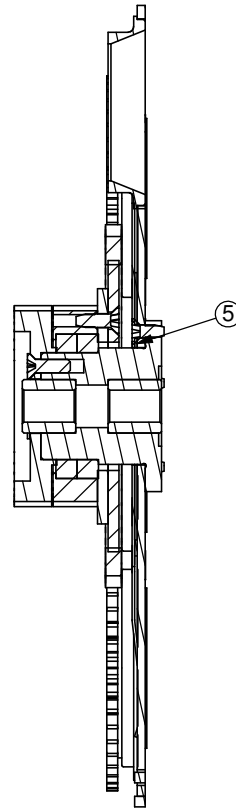
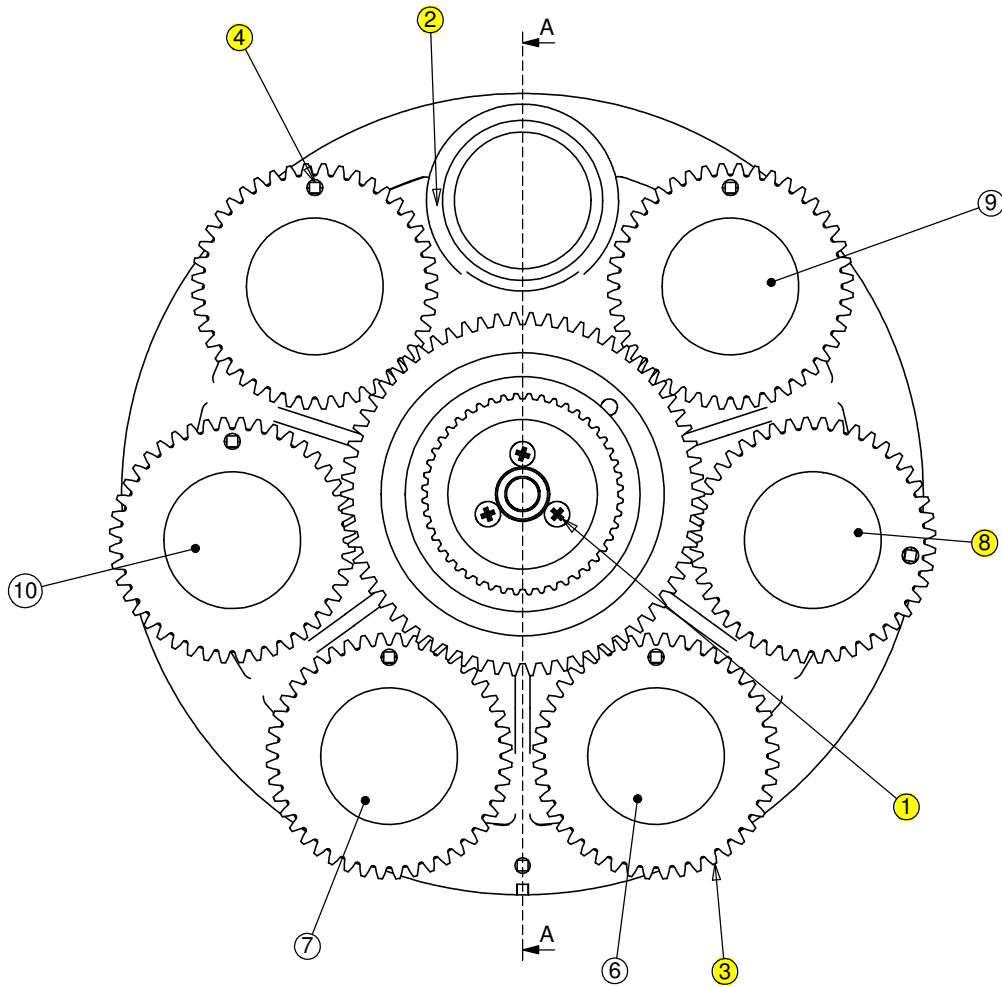

SECTION A-A

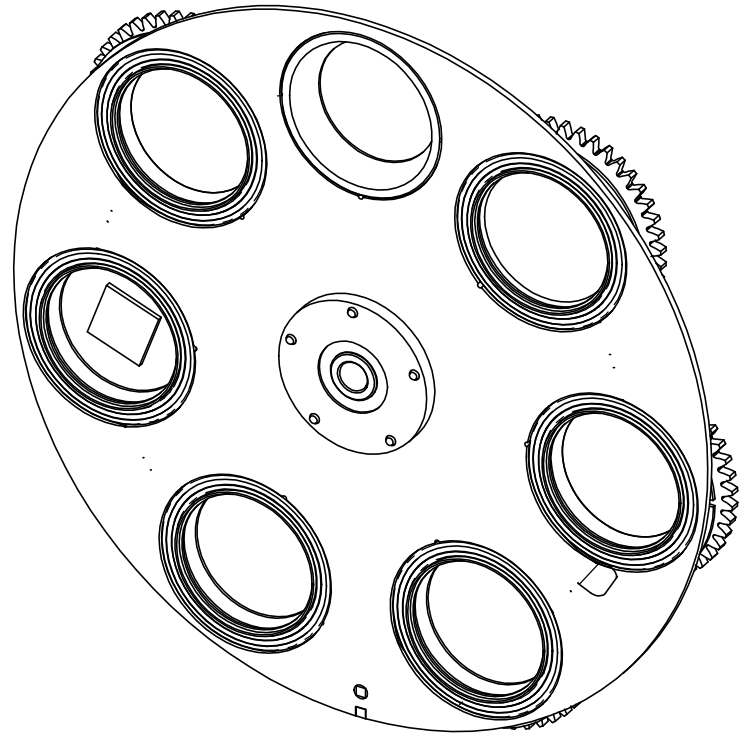

A				16.08.2007	rdtsa	First release
Rev.	Date	Resp.	CO no. / Comment			
Martin			First used in MAC 200	Material		
Item to be			General linear tolerance			
Item to be			General angular tolerance			
Item to be		Color	Format A3	Scale 1:1	Unit mm	
Description (Model in view 62325126-A)				Item no.-Rev.		
Rot gobo wheel with gobos				62325126-A		

ITEM NO.	PART NUMBER	DESCRIPTION	QTY.
1	23401990-C	Yoke outer cover, Mac 200	1
2	62400134-A	silicone tube d=3 D=7 L=6mm	2
3	08070712-A	M4x20 bh torx black	2

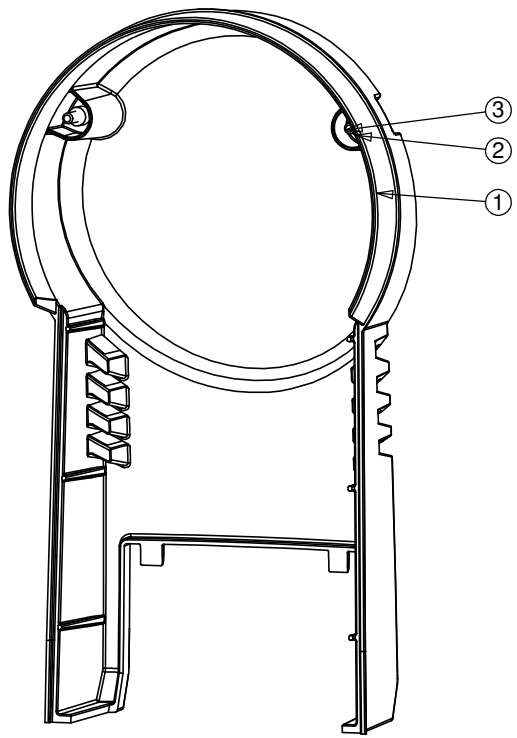

A	14.05.2007	rdtsa	First release		
Rev.	Date	Resp.	CO no. / Comment		
Martin		First used in MAC 200	Material		
Item to be		General linear tolerance			
Item to be		General angular tolerance			
Item to be		Color	Format A3	Scale 1:5	Unit mm
Description (Model in view 62406100-A)			Item no.-Rev.		
Yoke side cover. MAC200			62406100-A		

ITEM NO.	PART NUMBER	DESCRIPTION	QTY.
1	23402010-B	Base sidecover	1
2	62400134-A	silicone tube d=3 D=7 L=6mm	4
3	08070712-A	M4x20 bh torx black	4

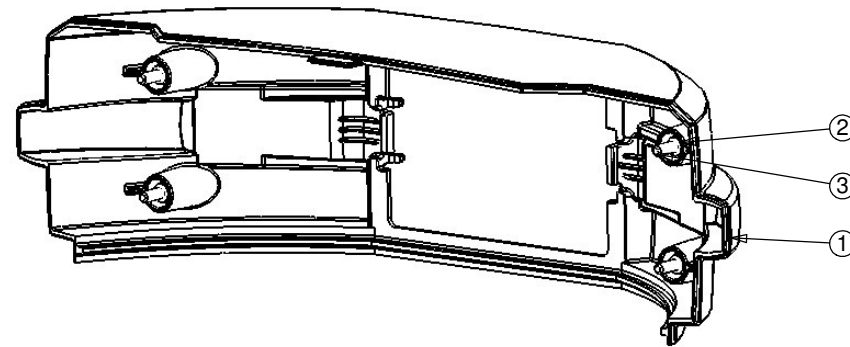

A	04.04.2007	rdtsa First release
Rev.	Date	Resp. CO no. / Comment
Martin	First used in MAC 200	Material
Item to be		General linear tolerance
Item to be		General angular tolerance
Item to be	Color	Format Scale Unit A3 1:5 mm
Description (Model in view 62406080-A)		Item no.-Rev.
Base sidecover asm		62406080-A

ITEM NO.	PART NUMBER	DESCRIPTION	QTY.
1	23402050-B	Base interfacecover B	1
2	18640070-B	Lightguide base display	1

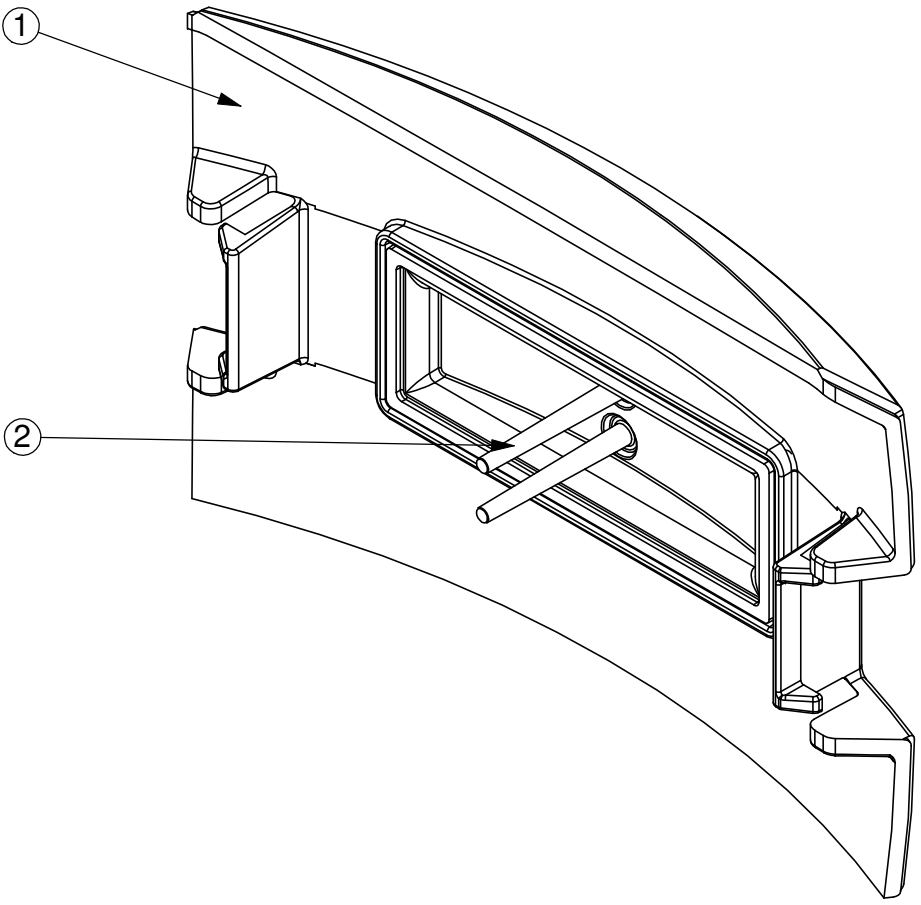

First degrease then glue
Glue: 37000801Siliconglue clear, lowtemp.dow

Rev.	Date	Resp.	CO no. / Comment
A	21.12.2007	RD_TSA	First release
Item to be		Material	
Item to be		General linear tolerance	
Item to be		General angular tolerance	
Item to be		Color	
Format	Scale	Unit	
A4	1:1	mm	
Description (Model in view 62328025-A)			Item no.-Rev.
smartMAC display cover			62328025-A

ITEM NO.	PART NUMBER	DESCRIPTION	QTY.
1	19440130-A	TPE rubber foot	4
2	08074303-A	M4 washer 4,3/10x1,25 shiny	4
3	08070701-A	M4x10 ph torx tapt spike black	4
4	08070804-A	M4x10 cs torx tapt black	3
5	08070702-A	M4x6 ph torx tapt spike black	4
6	08070805-A	M4x8 cs torx tapt spikes black	1
7	23903250-B	Base bottom cover SM, printed	1
8	08222016-A	Safety wire rod	1
9	23812580-D	Safety wire housing	1

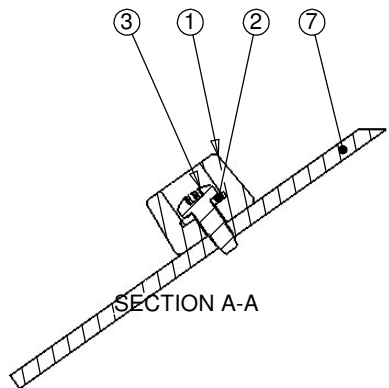
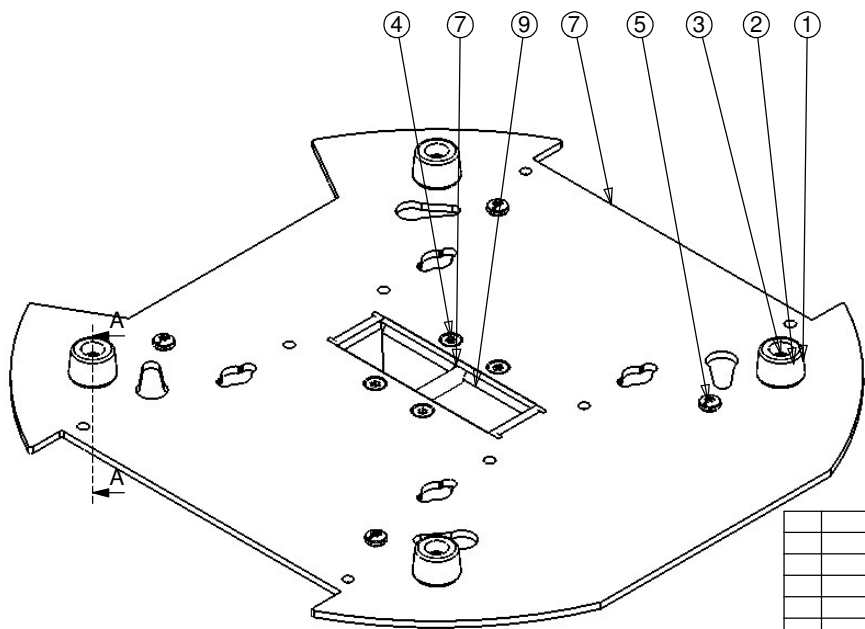
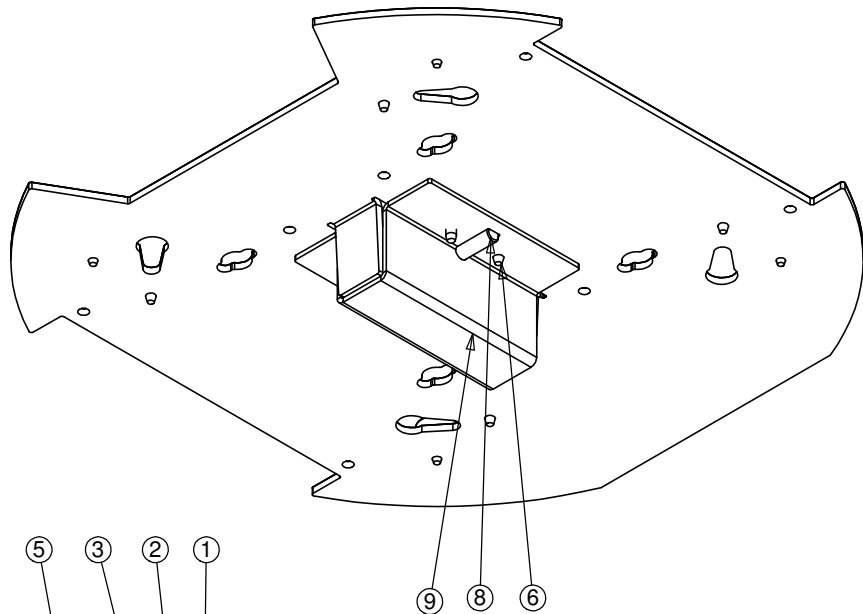

A	07.02.2007	rdtsa	First Release
Rev.	Date	Resp.	CO no. / Comment
Martin			Material
Item to be			First used in MAC 200
Item to be			General linear tolerance
Item to be			General angular tolerance
Item to be			Color
Description (Model in view 62406075-B)			Format Scale Unit A3 1:1 mm
Bottom plate asm			Item no.-Rev. 62406075-B

ITEM NO.	PART NUMBER	DESCRIPTION	QTY.
1	62406106-B	Main PCB bracket	1
2	08261001-A	Spacer $\varnothing 3,2/\varnothing 6 \times 4$ shiny	4
3	08052701	M3 lock nut	4
4	05061018-A	Thermal gab filler 7,5x13x2	7
5	62090174-A	PCB smartMAC Mainboard	1

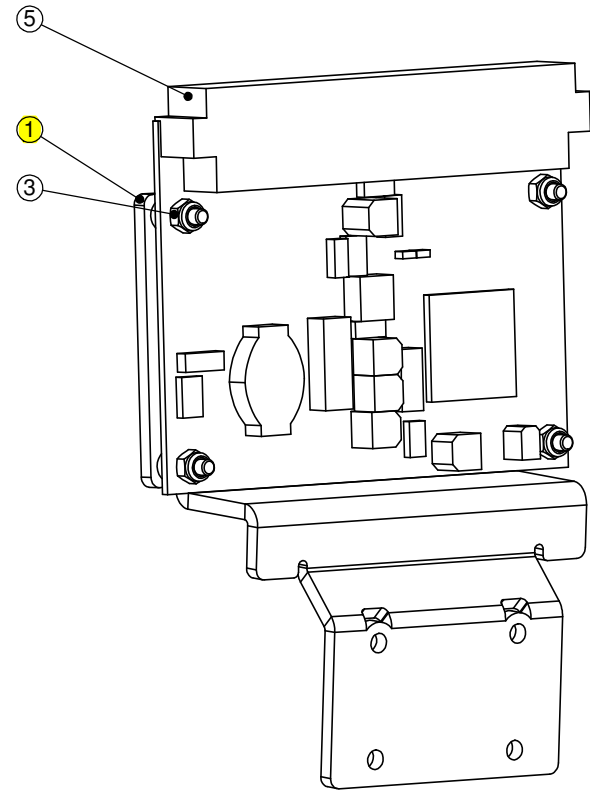
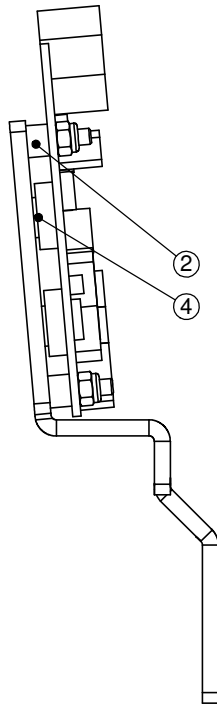
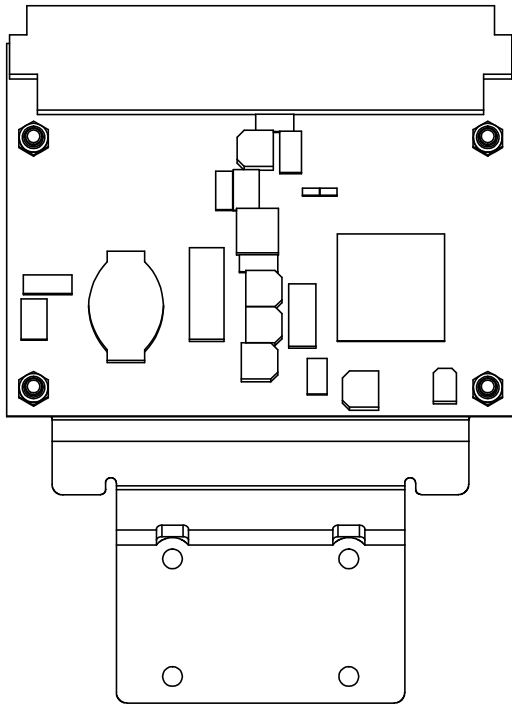

A	26.11.2007	rdtsa	First release		
Rev.	Date	Resp.	CO no. / Comment		
Martin		First used in		Material	
Item to be				General linear tolerance	
Item to be				General angular tolerance	
Item to be			Color	Format A3	Scale 1:1
Item to be			Unit mm		
Description (Model in view 55231007 PCB module)				Item no.-Rev.	
PCB module smartMAC				55231007 PCB m	

