



## MODULA CAT<sup>PRO</sup>™ Configuration Guide

Receive, route, and transmit uncompressed RGBHV + stereo over category cable without worrying about exact measurements or re-adjusting gain, peak, and skew when routing signal paths of various lengths.

For even more flexibility, combine CAT-5, HD-15, and stereo audio boards in the same system – and route between them with ease.

- Intuitive gain, peak, and skew adjustments via the CatPro Software Wizard
- Resolutions up to 1600x1200 @ 60 Hz and 1920x1080 @ 60 Hz
- Compatible with UTP and STP category cable (5, 5e, 6, 6e ...)
- CAT-5 signal paths up to 1,000 feet

*There are dozens of possible configurations ... here are just two examples to get you started.*

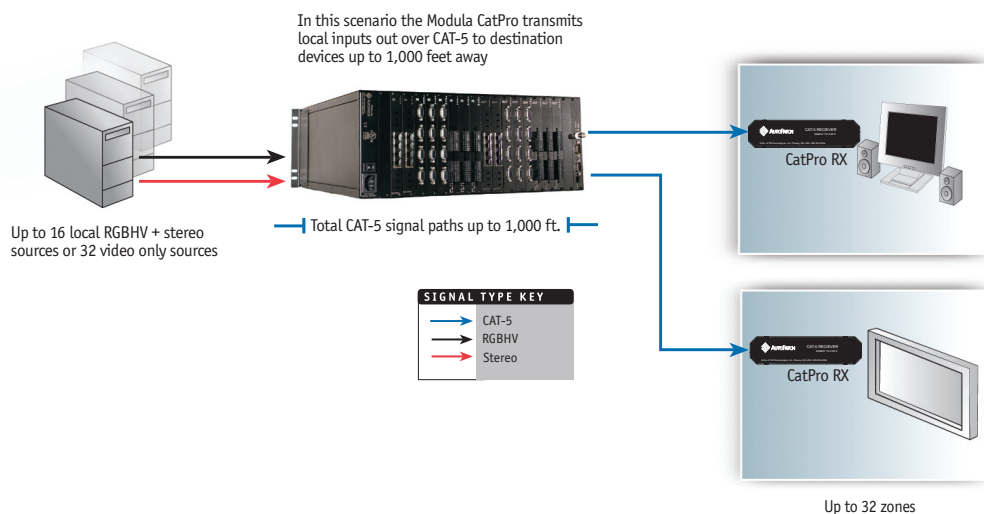
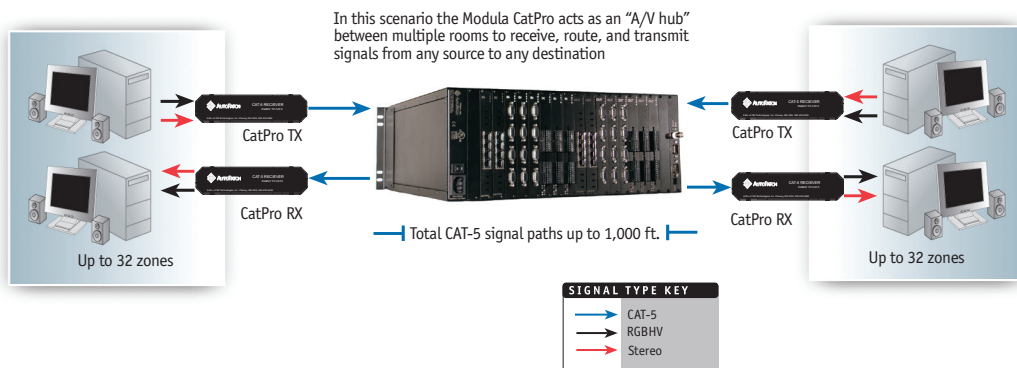

Contact AutoPatch today at 800.622.0246 or visit [www.autopatch.com](http://www.autopatch.com) for more information on the new Modula CatPro and our full line of professional signal management solutions.





## Modula CAT<sup>PRO</sup>™ Configuration Guide

The Modula CatPro is customizable; simply choose from the available input and output boards to build the system in increments of four inputs and/or outputs. Each Modula CatPro enclosure can hold up to eight input boards and eight output boards.

RGBHV and stereo sources transmitted over CAT-5 at the source can be routed into the Modula over RJ-45 input connections. Each board has 4 input connections. In this case, both the RGBHV and stereo signals are combined over a single CAT-5 cable thus one 4 connection input board will receive 4 RGBHV + stereo signals.

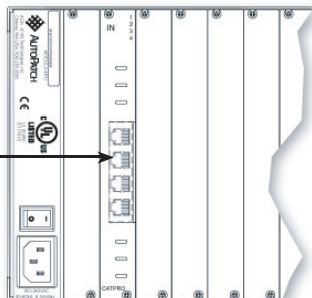

RGBHV sources can also be connected directly to the Modula via HD-15 connections. Each board has 4 input connections. Stereo sources can be connected directly into the Modula via phoenix style connections (5T). Each board has 4 input connections.

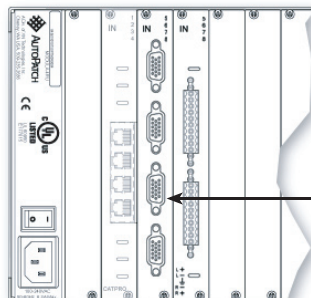

RGBHV and stereo sources can then be transmitted out of the Modula over CAT-5 via RJ-45 output connections as well as routed out over HD-15 and phoenix style connectors at the same time. This ultimate flexibility allows for any source to be sent to any destination. For maximum video performance, we recommend each signal path does not exceed 1,000 feet.

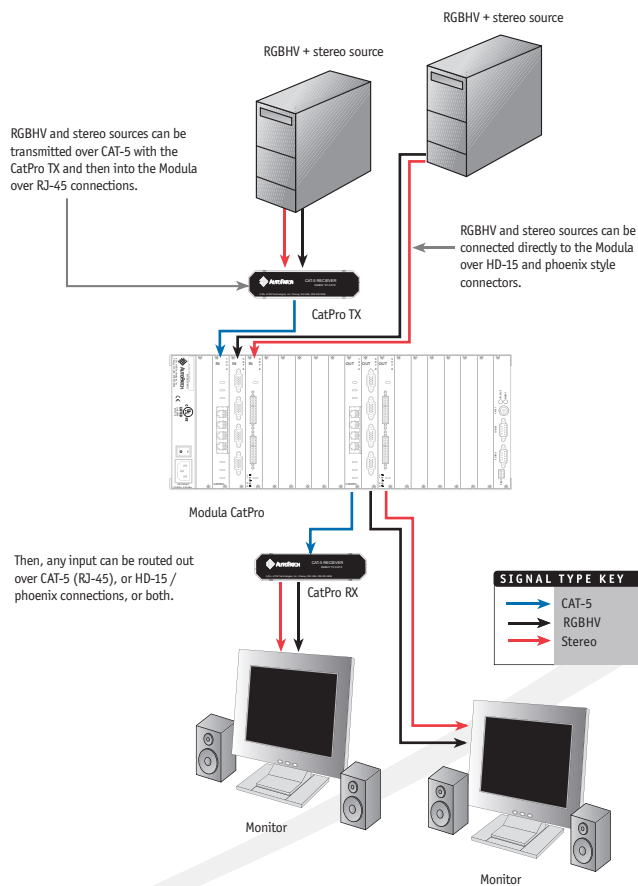
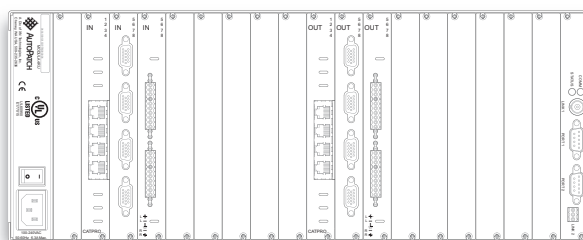

**Simple gain, peak, and skew adjustments**

Once your system is set up, there is no need to readjust when switching between sources and devices that have different distance runs. Our user-intuitive CatPro Software Wizard allows for simple adjustment of gain, peak, and skew on every CAT-5 input received. This brings all signals back to a distance of zero – ready to be sent to any destination device without the hassle of readjustment. If the signals are then retransmitted out CAT-5 a CatPro Receiver Module located at the destination device adjusts for the cable length between the router and RX module.



**AUTOPATCH™**  
High Performance Signal Routing

2416 Cheney-Spokane Rd.  
P.O. Box 350 Cheney, WA 99004-0350  
phone: 800.622.0246 US & Canada  
fax: 509.235.2646  
web: [www.autopatch.com](http://www.autopatch.com)

Unit 3 Green Park Business Centre  
Goose Lane  
Sutton-on-the-Forest  
York  
YO61 1ET  
phone: +44 (0) 1347 812310  
fax: +44 (0) 1347 812322