

Overview

The HPX-AC-SB HydraPort Stop Block Module (FG559-01) is designed to be used in conjunction with the HPX-1600 HydraPort Base Assembly. See specifications for module requirements. For more information on the HPX-1600, refer to www.amx.com.

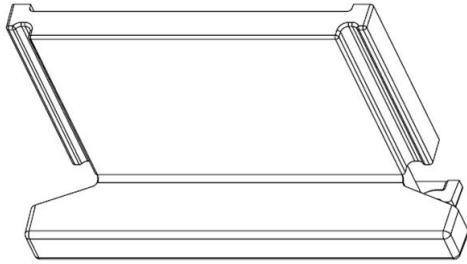

FIG. 1 HPX-AC-SB STOP BLOCK MODULE

The HPX-AC-SB provides a means to limit the upward travel of the HPX-1600 HydraPort Base Assembly when using fewer than the maximum number of modules. This limits the number of blank modules exposed to the user.

Product Specifications

HPX-AC-SB SPECIFICATIONS	
Dimensions (HWD)	50mm x 52mm x 19mm (1.96" x 2.05" x 0.75")
Weight:	0.05 Kg (1.76 oz.)
Enclosure:	Matt black finished face plate (Polycarbonate plastic).
Compatibility:	HPX-1600 HydraPort Base Assembly
Included Accessories:	Installation Guide

Installation

Attention! Only a professional, AMX-qualified installer should perform this installation. Installation must conform to all local codes. This product may not be installed by the end-user.

Tools Required

- Phillips Screw Driver (to access HydraPort Base Assembly)

CAUTION! Ensure that the AC Power cord is disconnected from IEC C-14 power inlet connector on the HydraPort Base Assembly prior to disassembly of the HydraPort Base assembly or installation of the HPX-AC-SB Module (see FIG. 2).

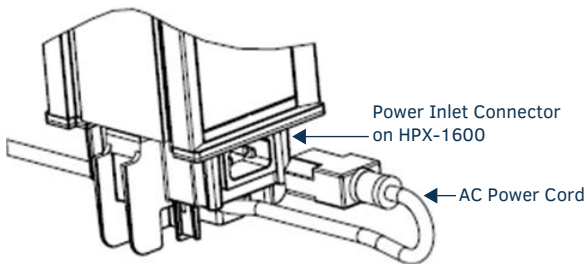

FIG. 2 HPX-1600 - POWER INLET CORD REMOVED

Step 1 - Determine the Required Position of the Stop Block

The level of the mounting surface (Table Line) will be approximately "2M" 50mm (2") above the top of the Stop Block module after final installation (FIG. 3).

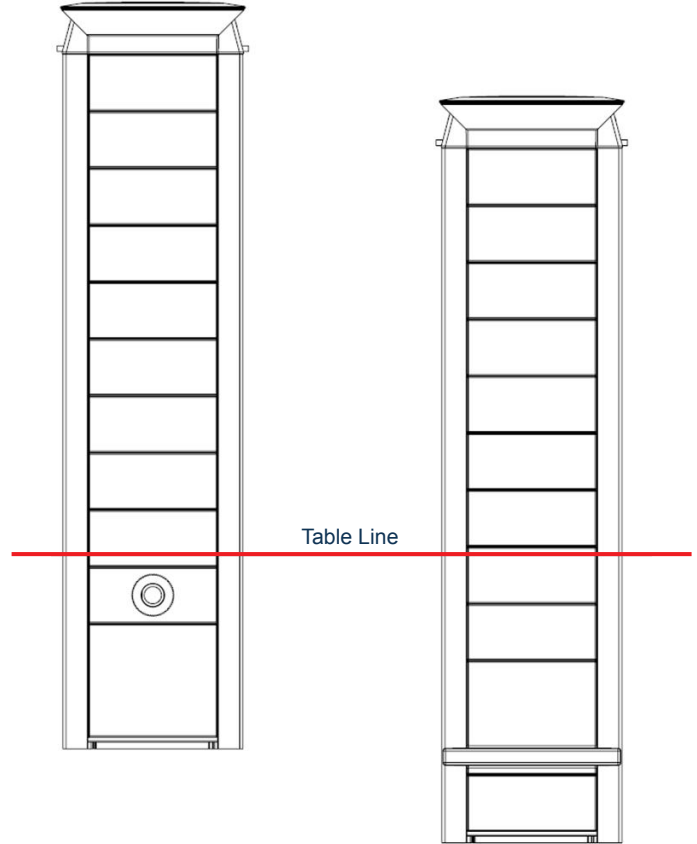

FIG. 3 POSITION OF TABLE LINE RELATIVE TO STOP BLOCK

Use the 2M Blank Module (HPX-B200) provided in the HPX-1600 Base Assembly or other combinations of 1M Blank Modules (HPX-B100) and/or Circuit Breaker Modules (HPX-PAK-1) to occupy this space above the Stop Block.

Step 2 - Insert the Module Into the HPX-1600 Chassis

Insert the module into the main chassis of the HPX-1600 Base Assembly.

Note: The position of module interlock tab should face towards the bottom of the HPX-1600 Base assembly when installed in its mounted position (FIG. 4).

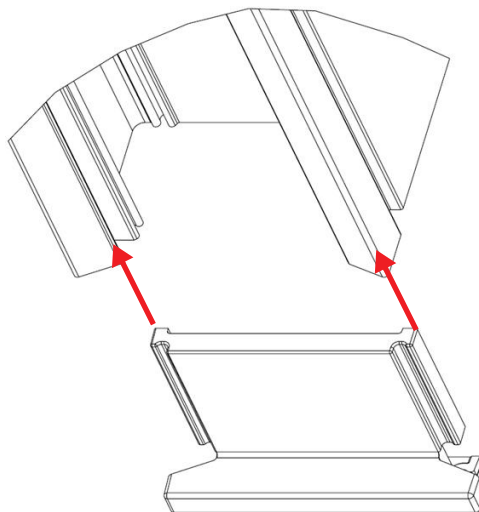

FIG. 4 INSERTING THE MODULE INTO THE HPX-1600 CHASSIS

Step 3 - Install the Bottom Cover On the HPX-1600

Complete the assembly by installing additional Blank Modules (HPX-B100 or HPX-B200) below the stop block.

Note: Install any remaining modules into the HydraPort Base Assembly before installing the Bottom Cover on the HPX-1600.

1. Install the bottom cover (including the Power Inlet Assembly) onto the bottom of the main frame of the HydraPort Base Assembly.
The cables from the HPX-N100-USB Module as well as all other modules (except AC Power Outlets) will exit the bottom of the HydraPort Base Assembly through one of four square passages on either side of the bottom cover.
2. After the bottom cover is secured using four screws, secure the cables to the corresponding tab near each opening using a small cable tie (FIG. 5).

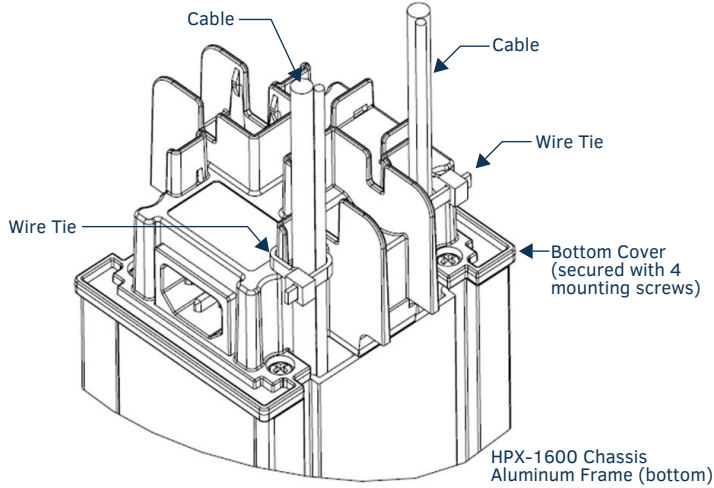

FIG. 5 BOTTOM COVER - INSTALLED WITH CABLES EXITING AND SECURED

