

## Overview

The HydraPort Retractable Cable Modules are designed to be used in conjunction with the HPX-600/900/1200 and a HydraPort Touch (7"/10") Connection Port base assembly, to provide the convenience of various types of cables in a HydraPort System. The **HPX-AV102-RGB+A-R** RGB+Audio Module with Retractable Cable (FG552-31) provides a user-accessible RGB+Audio cable in a retractable spool that mounts into the HydraPort base assembly (FIG. 1).

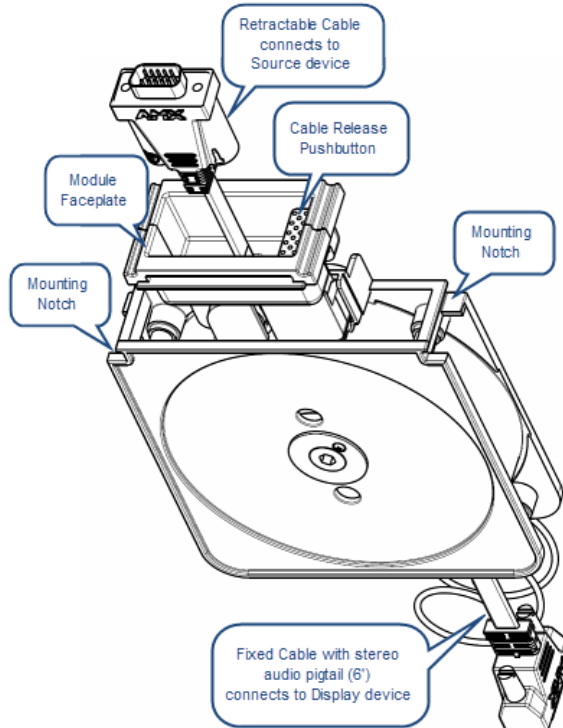

FIG. 1 HPX-AV102-RGB+A-R RGB+AUDIO MODULE WITH RETRACTABLE CABLE

### Retractable (Source) RGB+Audio Connector: 3.5mm Ports

Note that the retractable cable (which connects to the Source device) features two 3.5mm ports, one on either side of the RGB connector (FIG. 2):

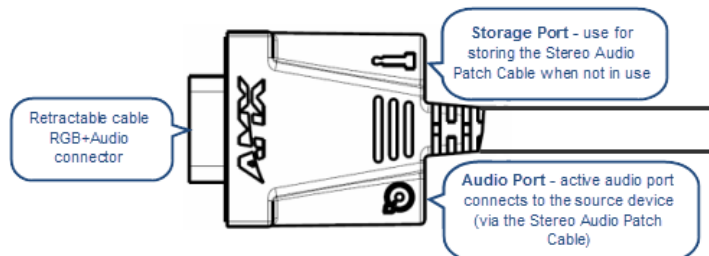

FIG. 2 RETRACTABLE (SOURCE) RGB+AUDIO CONNECTOR (STORAGE AND AUDIO PORTS)

- The port with the **Speaker** icon is the active audio port - use this port to connect to the source device's audio output (via the Stereo Audio Patch Cable).
- The port with the **Plug** icon is an *inactive* storage port for the Stereo Audio Patch Cable.

**Note:** Always keep the Stereo Audio Patch Cable plugged into this storage port when not in use. This is to both protect the plug, and to avoid the potential for noise on this cable.

## Mounting Dimensions

FIG. 3 provides dimensions for the retractable cable module, when installed in an HydraPort base assembly:

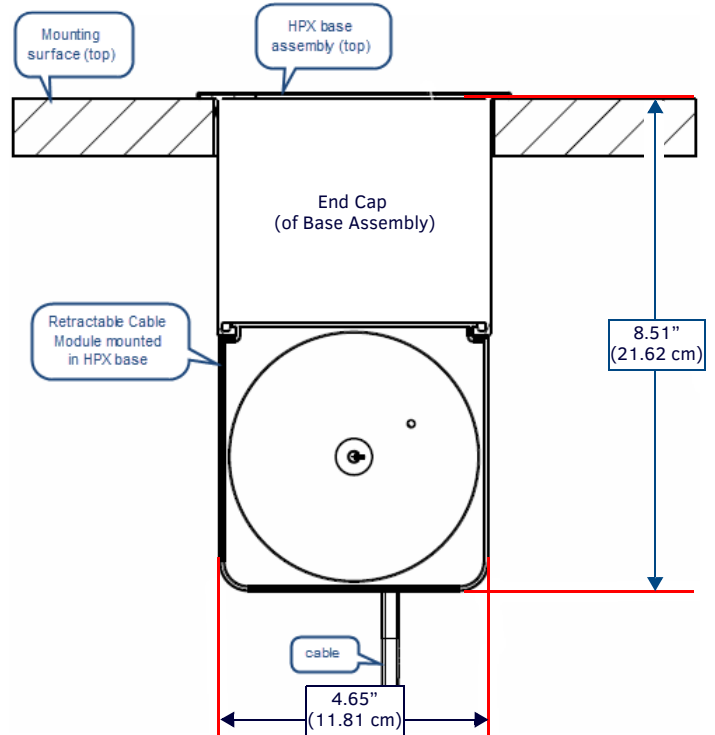

FIG. 3 RCM MODULE (INSTALLED IN AN HYDRAPORT BASE) - DETAILED DIMENSIONS

## Installation

**Warning!** - Do not attempt to open the retractable cable module enclosure. There are no serviceable parts inside the module.

- Opening the module enclosure may result in an uncontrolled release of spring forces which could cause serious injury and/or equipment damage.
- Opening the module enclosure will void the product warranty.

**Warning!** - The placement of the HydraPort installation in the table should ensure the pull-out length of the cable can reach all potential users of connectivity, as excessively pulling on a pulled-out cable can irreparably damage the retractor module.

**Caution:** Only use a manual screwdriver for the mounting instructions in this document. Over-tightening the screws can hinder performance or damage the product.

### 1. For Existing HydraPort Installations

For new HydraPort installations, skip to Step 2.

For existing HydraPort installations, the HydraPort Base Assembly must be un-mounted from the surface before the Retractable Cable Modules can be installed:

- Cut/remove any cable ties that would restrict the removal of the HydraPort Base Assembly.
- Loosen the four mounting screws (located inside and at each end of the HydraPort base assembly), in order to rotate the retaining tabs from under the mounting surface.

Note that when the cover of the HydraPort base is open, only two of these screws are visible. To access the other two mounting screws, tip the cover over to the opposite open position (see FIG. 4).

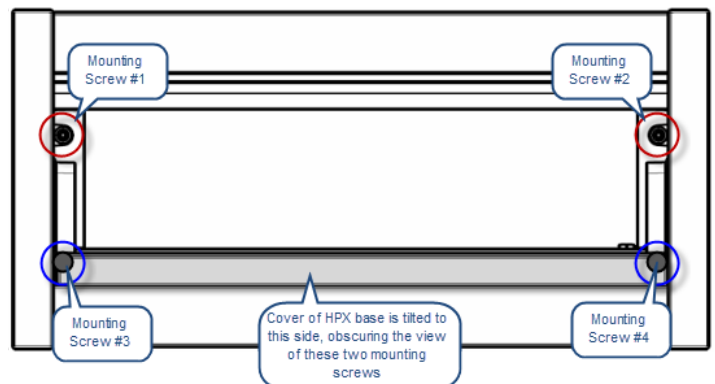

FIG. 4 HYDRAPORT BASE ASSEMBLY (SHOWN MOUNTED) - MOUNTING SCREWS LOCATIONS

- Once the retaining tabs have been rotated out from under the mounting surface, the HydraPort assembly can be lifted away from the mounting surface.

FIG. 5 provides a cutaway view of the End Cap, showing the retaining tabs in both the loose position and the tightened (secure) position:

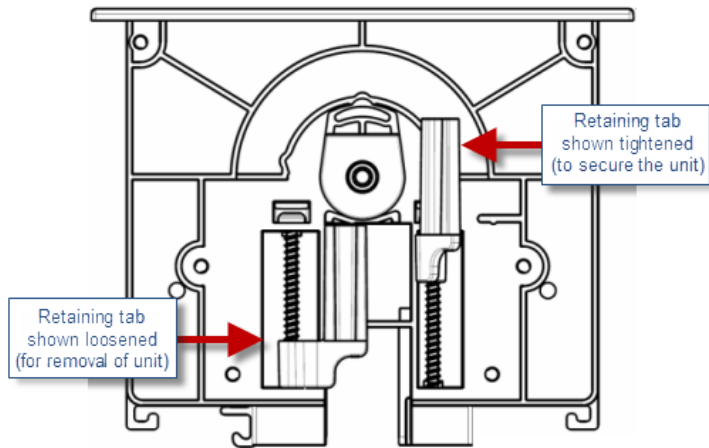

FIG. 5 HYDRAPORT BASE ASSEMBLY (SHOWN MOUNTED) - MOUNTING SCREWS LOCATIONS

## 2. Remove the End Cap and Existing Modules

Remove the End Cap as well as existing modules (as necessary, depending on how you want the modules arranged) from one end of the HydraPort base assembly.

- Remove the (silver) pivot screw and pivot pawl assembly in the center of the End Cap (FIG. 6).
- Remove the six (black) sheet metal screws that secure the End Cap to the HydraPort assembly (locations highlighted in FIG. 6).

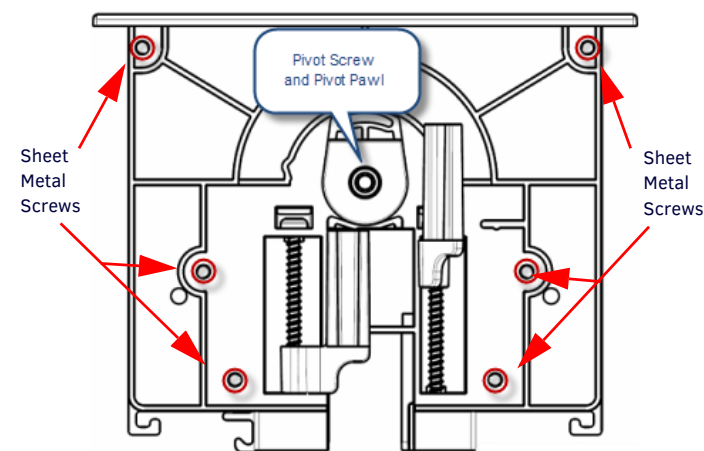

FIG. 6 HYDRAPORT BASE ASSEMBLY (SHOWN MOUNTED) - MOUNTING/PIVOT SCREW LOCATIONS

- Gently slide the End Cap out of the HydraPort base assembly.

## 3. Insert the Retractable Cable Module into the HydraPort Base

- Orient the module relative to the HydraPort base assembly so that the Module's faceplate is facing up, towards the mounting surface (FIG. 7).

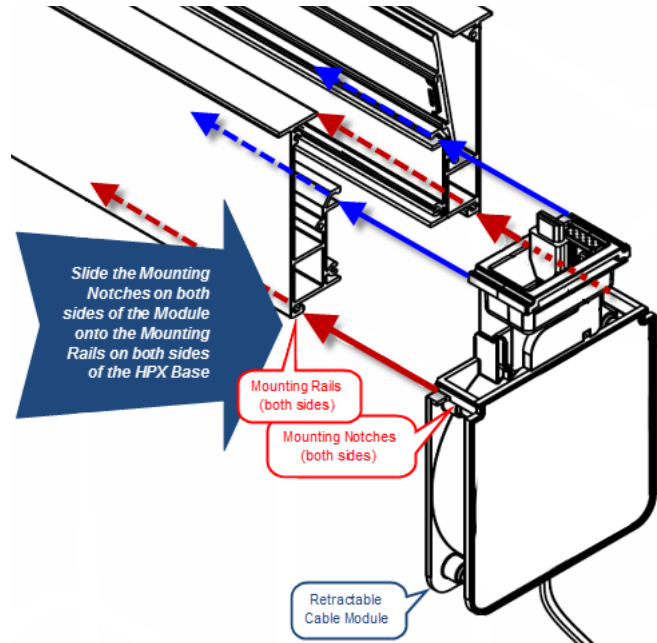

FIG. 7 RETRACTABLE CABLE MODULE - MOUNTING INTO AN HYDRAPORT BASE ASSEMBLY

- Align the Mounting Notches on the module with the Mounting Rails on the HydraPort base.

**Note:** Module face plates are notched in a "tongue and groove" type fashion to ensure that all modules are oriented correctly in the HydraPort. Note the orientation of the notched faceplate on each module before sliding the module(s) into the HydraPort assembly.

- Slide the module into position.
- Install any remaining modules into the HydraPort base.

## 4. Re-Install the End-Cap

**Caution:** Do not use a high-powered torque screwdriver. Over-tightening these screws can damage the product.

- Align the Mounting Notches on the End Cap with the Mounting Rails on the HydraPort base.
- Slide the End Cap into the HydraPort base until it is fully inserted against the end of the base assembly.
- Secure the End Cap with the six (black) sheet metal screws (removed in Step 2 - 2; see FIG. 6).
- Replace the (silver) pivot screw and pivot pawl assembly (removed in Step 2 - 1, see FIG. 6) in the center of the End Cap.

## 5. Mount the HydraPort into the Mounting Surface

**Caution:** Do not use a high-powered torque screwdriver. Over-tightening these screws can damage the product.

**Note:** For detailed instructions on installing the HydraPort base assembly, refer to the HPX-600/900/1200 or HydraPort Touch Installation Guides (available online at [www.amx.com](http://www.amx.com)).

- Carefully insert the HydraPort base into the cutout in the mounting surface.
- Tighten the four mounting screws (loosened in Step 1, see FIG. 5) located inside and at each end of the HydraPort base assembly, to rotate the retaining tabs into locking position under the mounting surface.

## 6. Terminate Fixed Cables

- Terminate fixed cables as necessary.

**Note:** Use of an extension cable on either end of this cable should be avoided to ensure optimal performance.

- Replace any cable ties that were removed in Step 1.

## Additional Documentation

Refer to the *Products > Architectural Connectivity* catalog page on [www.amx.com](http://www.amx.com) (Dealer Site) for additional product documentation.



© 2015 Harman. All rights reserved. Hydraport, AMX, AV FOR AN IT WORLD, HARMAN, and their respective logos are registered trademarks of HARMAN. Oracle, Java and any other company or brand name referenced may be trademarks/registered trademarks of their respective companies.

AMX does not assume responsibility for errors or omissions. AMX also reserves the right to alter specifications without prior notice at any time. The AMX Warranty and Return Policy and related documents can be viewed/downloaded at [www.amx.com](http://www.amx.com).

3000 RESEARCH DRIVE, RICHARDSON, TX 75082 AMX.com | 800.222.0193 | 469.624.8000 | +1.469.624.7400 | fax 469.624.7153

AMX (UK) LTD, AMX by HARMAN - Auster Road, Clifton Moor, York, YO30 4GD United Kingdom • +44 1904-343-100 • [www.amx.com/eu/](http://www.amx.com/eu/)

Last Revised: 8/05/2015

93-0552-31 REV: D

