

**Overview**

The MXA-UENET-PAN Video Acceleration accessory cable (FG5968-74) plugs into a USB port of the Modero X Series® Touch Panel and routes Ethernet traffic into the Modero X Series USB subsystem, which has been optimized to further accelerate streaming video performance (FIG. 1).

Within the Modero X Series touch panels, streaming video is optimized via the use of the MXA-MPL Multi Preview Live (FG5968-10). If using an MXA-MPL is not an option, the MXA-UENET-PAN video acceleration cable may be used to connect streaming video feeds to the MXT/D-1900L-PAN and MXT/D-2000XL-PAN touch panels.



FIG. 1 MXA-UENET-PAN

**Specifications**

MXA-UENET-PAN (FG5968-74) SPECIFICATIONS	
Length:	6' (1.83 m)
Weight:	0.25 lbs (113.40 g)
Included Accessories:	MXA-UENET-PAN Installation Guide (93-5968-74)
Other AMX Equipment:	<ul style="list-style-type: none"> <li>MXT-1900L-PAN 19.4" Modero X Series Panoramic Tabletop Touch Panel (FG5968-02)</li> <li>MXT-2000XL-PAN 20.3" Modero X Series Panoramic Tabletop Touch Panel (FG5968-01)</li> <li>MXD-1900L-PAN-L 19.4" Modero X Series Panoramic Wall/Flush Mount Touch Panel, Landscape (FG5968-12)</li> <li>MXD-1900L-PAN-P 19.4" Modero X Series Panoramic Wall/Flush Mount Touch Panel, Portrait (FG5968-06)</li> <li>MXD-2000XL-PAN-L 20.3" Modero X Series Panoramic Wall/Flush Mount Touch Panel, Landscape (FG5968-11)</li> <li>MXD-2000XL-PAN-P 20.3" Modero X Series Panoramic Wall/Flush Mount Touch Panel, Portrait (FG5968-05)</li> </ul>

**Installation for Tabletop Touch Panels**

To connect your MXT-1900L-PAN or MXT-2000XL-PAN tabletop touch panel to the network via the MXA-UENET-PAN:

1. Connect the USB plug on the MXA-UENET-PAN to the touch panel via the USB port on the underside of the device (FIG. 2).

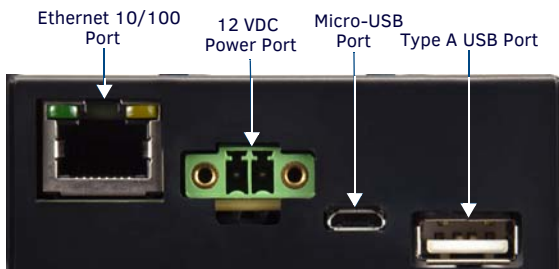

FIG. 2 MXT-2000XL-PAN UNDERSIDE CONNECTORS

2. If necessary, use the tie wrap channels running along the bottom of the device to lock down the cable (FIG. 3).
3. Connect the Ethernet port on the MXA-UENET-PAN (FIG. 1) to the network via CAT5 Ethernet cable and apply power.

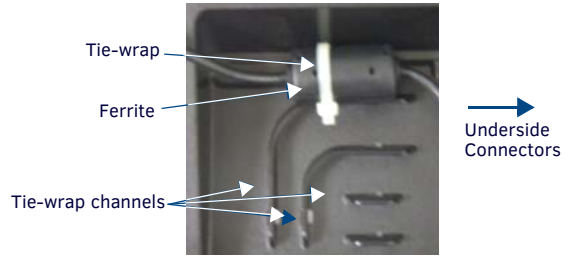

FIG. 3 TIE WRAP CHANNELS

**Installation for Wall/Flush Mount Touch Panels**

To connect your MXD-1900L-PAN or MXD-2000XL-PAN wall/flush mount touch panel to the network via the MXA-UENET-PAN:

*NOTE: If the touch panel has already been installed in the wall or mounting surface, the touch panel and the back box must be removed from the mounting surface to install the MXA-UENET-PAN. Thread the connecting CAT5 Ethernet cable through the back box hole before installing the MXA-UENET-PAN. In new installations, separate the back box from the touch panel, as the back box must have the MXA-UENET-PAN threaded through it before the touch panel can be installed.*

1. Connect the Ethernet port on the MXA-UENET-PAN (FIG. 1) to the network via CAT5 Ethernet cable.  
*NOTE: In solid-wall installations, make sure to have clearance within the wall for the Ethernet port jack and the excess cable before starting the installation.*
2. For best results, the USB connector on the MXA-UENET-PAN should be connected to the upper USB port on the touch panel.  
To facilitate this, when looking at the front of the back box as it installs into the wall, remove the top left knockout in the back box (FIG. 4).

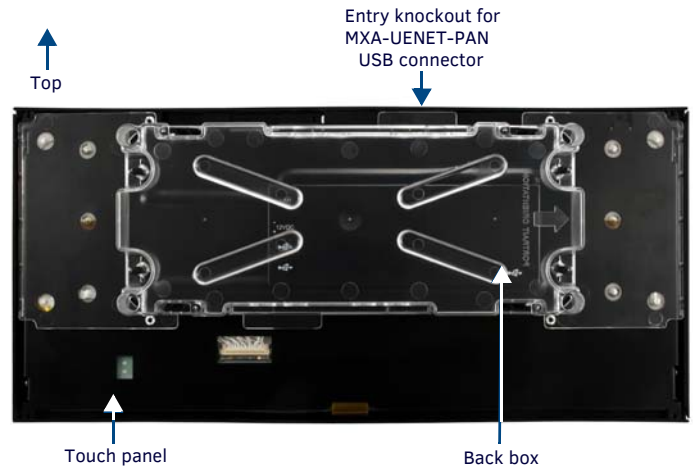
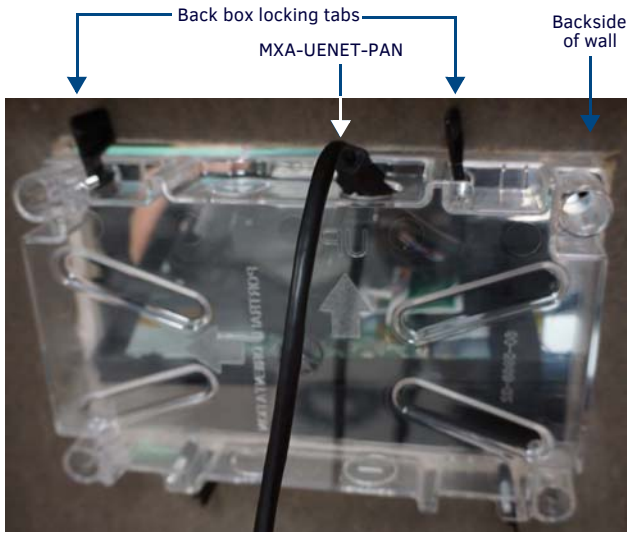

FIG. 4 REAR OF MXD-2000XL-PAN TOUCH PANEL, SHOWING BACK BOX

3. Thread the MXA-UENET-PAN through the knockout hole, and install the back box into the wall or mounting surface (FIG. 5).  
Lock down the back box using the back box's locking tabs for drywall installations or with screws (not included) for solid-wall or rough-in box installations.



**FIG. 5** INSTALLATION OF THE MXA-UENET-PAN INTO A BACK BOX

4. With the touch panel still outside of the back box, insert the USB connector into the touch panel's main USB port (FIG. 2).
5. Taking care not to dislodge or damage the USB connector, secure the touch panel into the back box and apply power.  
If necessary, draw in any slack on the MXA-UENET-PAN cable

## Configuring the Touch Panel to Receive the Video Stream

To receive streaming video from a network source:

1. In the touch panel's *Settings* Pages, select **Configuration > Advanced Config > Streaming Video**, entering the touch panel's password if necessary.
2. From the *Streaming Video* page, select *Enter URL* to open the *Set URL* keyboard.
3. Enter the URL for the video stream and click **OK**.

### Additional Documentation

The following additional product documentation is available at [www.amx.com](http://www.amx.com):

- *Installation Hardware Reference Manual - Modero X Series G5 Touch Panels*
- *Configuration and Programming Guide - Modero X Series G5 Touch Panels*

